

GRID NORTH NAD 83 NYS EAST ZONE-18

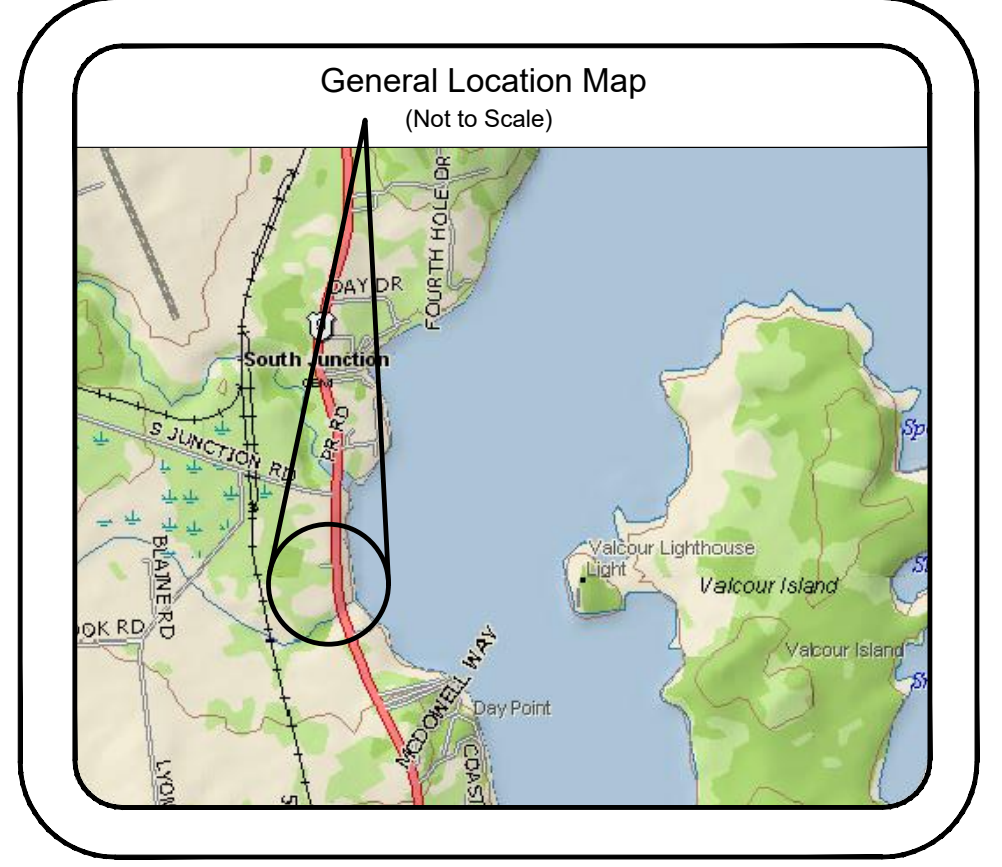

Tax Map Reference:
 Section 258 - Block 02 - Lot 2.3
 Section 258 - Block 02 - Lot 12
 Town of Plattsburgh / County of Clinton

Legend:

- 5/8" iron rod w/ RMS survey cap (to be set)
- Found property evidence (as described)
- Computed corner
- ⊕ Fire hydrant
- ⊙ Manhole
- ⊕ Water well
- ⊕ Water valve
- ⊕ Recovered concrete monument
- ☆ Lamp post
- Utility pole
- Ex Mooring
- Pr Mooring
- Property line
- Overhead utility line
- Building setback line
- Stone wall
- Fence
- Edge of woods

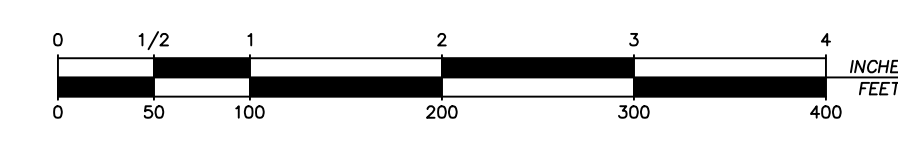
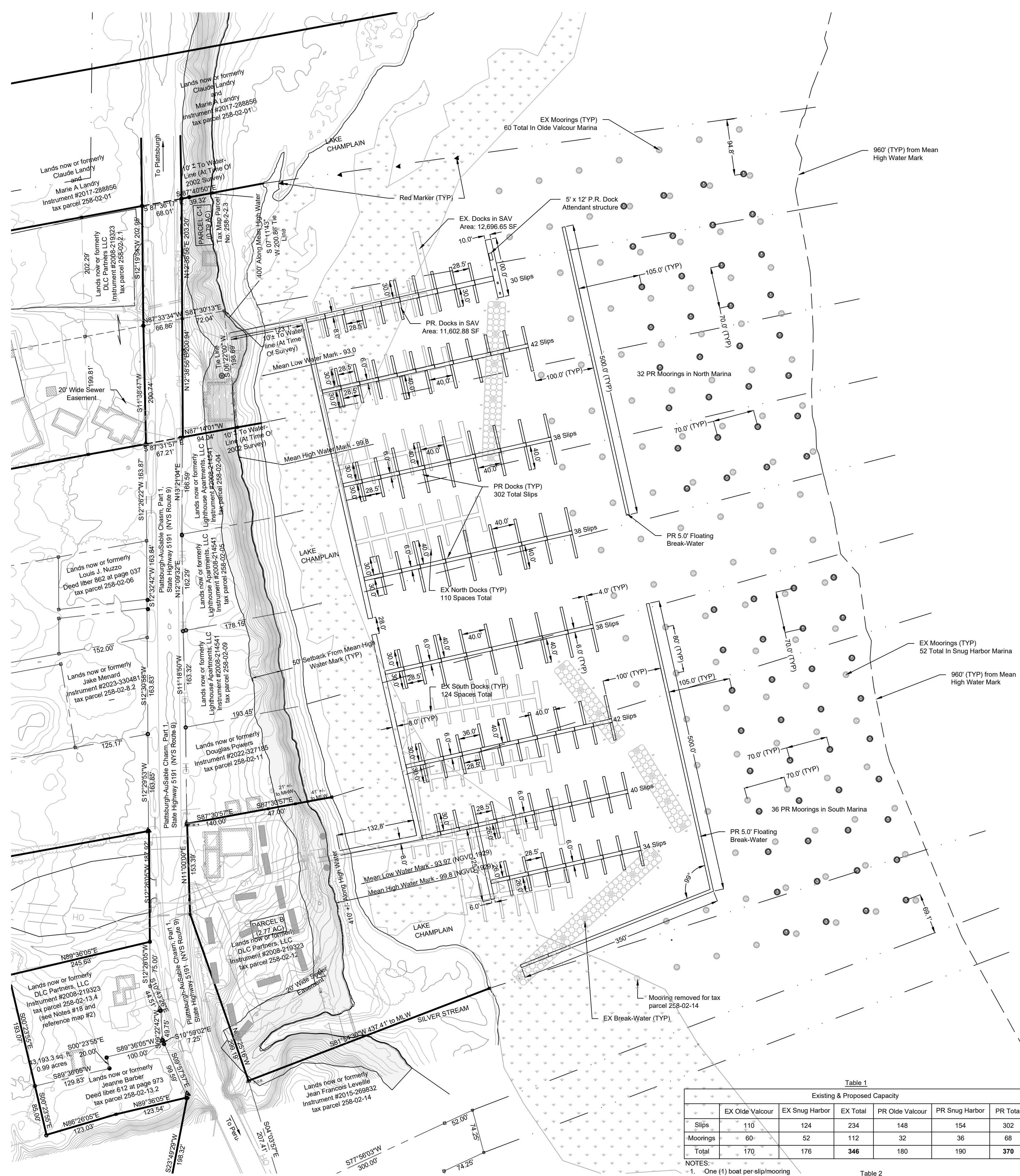

Table 1
Existing & Proposed Capacity

	EX Oldie Valcour	EX Snug Harbor	EX Total	PR Oldie Valcour	PR Snug Harbor	PR Total
Slips	110	124	234	148	154	302
Moorings	60	52	112	32	36	68
Total	170	176	346	180	190	370

Table 2
Existing & Proposed Breakwaters

	EX Oldie Valcour	EX Snug Harbor	EX Total	PR Oldie Valcour	PR Snug Harbor	PR Total
Width	30 LF	30 LF	60 LF	5 LF	5 LF	10 LF
Length	265 LF	640 LF	905 LF	500 LF	850 LF	1350 LF
Area	7,950 SF	19,200 SF	27,150 SF	2,500 SF	4,250 SF	6,750 SF

Table 3
Submerged Aquatic Vegetation (SAV)

EX Docks in SAV	Area: 12,696.65 SF
PR Docks in SAV	Area: 11,602.88 SF

NOTES:
 -1. One (1) boat per slip/mooring

No.	Revision/Issue	Date



Project Name & Address
 Map prepared for
Olde Valcour & Snug Harbor Marina
 - Situate -
 Stewart's Patent
 Town of Peru
 Clinton County State of New York

Project #	Sheet
24052	Current Permitted Configuration with Proposed Overlay
Date: 10/10/2024	C200
Scale: 1" = 100'	Checked: AJO
Drawn: TJS	

