





**SITE STATISTICS**

PARCEL ZONING: LIGHT INDUSTRIAL  
 SOLAR FACILITY: TIER III GROUND MOUNTED  
 TAX PARCEL NO.: 139.4-1-1.110  
 PARCEL SIZE: 254.99 ACRES

**PROPOSED DISTURBANCE FEATURE**

TOTAL TEMPORARY WETLAND DISTURBANCE - 1,904± SF (0.004± AC)  
 TOTAL PERMANENT WETLAND DISTURBANCE - 12,034± SF (0.276 AC)

**WETLAND DELINEATION NOTES:**

1. WETLAND DELINEATION PERFORMED BY QUENZER ENVIRONMENTAL WETLAND DELINEATION COMPLETED ON SEPTEMBER 30, 2019 AND WAS VERIFIED BY MS. MARY O'DELL OF THE ADIRONDACK PARK AGENCY. WETLANDS FLAGGING SURVEYED BY DARRAH LAND SURVEYING, PLLC.

**CONSTRUCTION WITHIN WATERS OF THE UNITED STATES AREAS NOTES:**

1. LOW GROUND PRESSURE CONSTRUCTION VEHICLES (6 PSI OR LESS) WILL BE UTILIZED IN ALL AREAS CONTAINING WATERS OF THE UNITED STATES (WOTUS). WHEN INSTALLING RACKING POSTS WITHIN WOTUS AREAS.
2. CONTRACTOR WILL MONITOR SITE CONDITIONS DAILY. CONTRACTOR WILL REFRAIN FROM MOVING TRACK MACHINERY INTO WOTUS AREAS DURING THE WET SEASON (APRIL 1ST - JUNE 1ST).
- 2.3. ALL RACKING POSTS SHALL BE POUNDED/VIBRATED INTO PLACE TO THE REQUIRED EMBEDMENT DEPTH IN ACCORDANCE WITH THE RACKING SYSTEM MANUFACTURER'S GUIDELINES. NO EXCAVATION IS ALLOWED TO SUPPORT RACKING INSTALLATION IN WOTUS AREAS. ADDITIONALLY:
  - 2.3.1. CONTRACTOR WILL PROVIDE EXTRA MANPOWER TO SAFELY UNLOAD AND STAGE RACKING POSTS IN A MANNER WHERE NO TURNS WILL BE MADE BY LOW GROUND PRESSURE EQUIPMENT WITHIN WOTUS AREAS.
  - 2.3.2. CONTRACTOR WILL DEPLOY TRACK-MOUNTED POST DRIVERS IN A MANNER WHERE NO TURNS BE MADE IN WOTUS AREA WHILE POSTS ARE POUNDED/VIBRATED INTO PLACE.
3. CONTRACTOR SHALL UTILIZE ALTERNATIVE WIRE MANAGEMENT METHODS WHERE ALL WIRING IS SUPPORTED BY THE RACKING TO AVOID TRENCHING IN THE WOTUS AREAS.
4. ALL OTHER ACTIVITIES NECESSARY TO SUPPORT CONSTRUCTION OF SOLAR PANEL EQUIPMENT IN WOTUS AREAS SHALL NOT USE MECHANIZED EQUIPMENT.
5. CONTRACTOR SHALL CONSTRUCT A COFFER DAM UPSTREAM OF THE CULVERT CROSSING LOCATION, AND THE OPEN TRENCH SHALL REMAIN DRY DURING THE INSTALLATION OF THE CULVERTS. CONTRACTOR TO FOLLOW THE WETLAND CROSSING DETAILS ON SHEETS 27 AND 28.
6. TREE-TRIMMING TO REDUCE SOLAR PANEL SHADING WITHIN THE WOTUS BUFFER AREAS WILL BE CONDUCTED BY HAND AND WASTE MATERIALS WILL BE REMOVED BY HAND. THERE WILL BE NO EARTH DISTURBANCE OR STUMP REMOVAL.
7. FENCE POSTS INSTALLED IN WOTUS AREAS WILL BE DRIVEN OR POUNDED INTO PLACE TO THE REQUIRED EMBEDMENT DEPTH. NO EXCAVATION IS ALLOWED TO SUPPORT FENCE INSTALLATION IN WOTUS AREAS.

**RESTORATION WITHIN WATERS OF THE UNITED STATES NOTES:**

1. THE WETLAND SEED MIXTURE SHALL BE USED IN ALL AREAS WHERE WETLANDS DISTURBANCE TAKES PLACE.
2. THE WETLAND SEED MIXTURE CAN BE SOWN BY HAND, WITH A HAND-HELD SPREADER, OR HYDRO-SEEDED ON LARGE OR HARD TO REACH SITES.
3. LIGHTLY RAKE TO INSURE GOOD SEED-TO-SOIL CONTACT.
4. SEEDING CAN TAKE PLACE ON FROZEN SOIL.
5. IF SPRING CONDITIONS ARE DRIER THAN USUAL WATERING MAY BE REQUIRED.
6. IF SOWING DURING THE SUMMER MONTHS SUPPLEMENTAL WATERING WILL LIKELY BE REQUIRED UNTIL GERMINATION.
7. A LIGHT MULCH OF CLEAN, WEED FREE STRAW IS RECOMMENDED.

**CLEARING WITHIN THE APA WETLAND BUFFER ZONE NOTES:**

1. THE 50 FT. WETLAND BUFFER SHALL REMAIN VEGETATED AND UNDISTURBED.
2. TO PREVENT PANEL SHADING, TREES WITHIN THE 50 FT. BUFFER AREA THAT ARE GREATER THAN 30 FEET SHALL BE SELECTIVELY TRIMMED. ALL TRIMMING ACTIVITY SHALL BE CONDUCTED BY HAND TO AVOID ANY DISTURBANCE WITHIN THE BUFFER ZONE.
3. SIMILARLY, DURING THE LONG-TERM OPERATION AND MAINTENANCE OF THE FACILITY, TREES WITHIN THE 50 FT. BUFFER AREA MAY BE SELECTIVELY TRIMMED BY HAND.

NEW YORK STATE  
 Adirondack Park Agency  
**FINAL**  
 P2020-0157

**WETLAND SEED MIXTURE SCHEDULE**

PLANTING ZONE	SCIENTIFIC NAME	COMMON NAME	PERCENT %	APPLICATION RATE	PLANTING PERIOD
ALL WETLAND DISTURBANCE AREAS	N SCIRPUS ATROVIRENS	GREEN BULRUSH	28.8	2 LBS/ ACRE	NOVEMBER TO DECEMBER
	N JUNCUS EFFUSUS	SOFT RUSH	13.0		
	N MIMULUS RINGENS	MONKEY FLOWER	12.0		
	N CAREX VULPIDEIDA	FOX SEDGE	8.4		
	N PENTHORUM SEDOIDES	DITCH STONE CROP	7.8		
	N GLYCERIA GRANDIS	REED MEADOWGRASS	6.7		
	N SCIRPUS CYPERRINUS	WOOL GRASS	5.2		
	N VERBENA HASTATA	BLUE VERVAIN	4.2		
	N EUPATORIUM PERFOOLIATUM	BONESET	2.1		
	N LEERSIA ORYZOIDES	RICE CUT GRASSAVENS	1.6		
N HELENIUM AUTUMNALE	COMMON SNEEZEWEED	1.5			
N GLYCERIA CANADENSIS	CANADA MANNAGRASS	1.4			

NOTE: ONLY LISTED SPECIES ABOVE 1.0%.

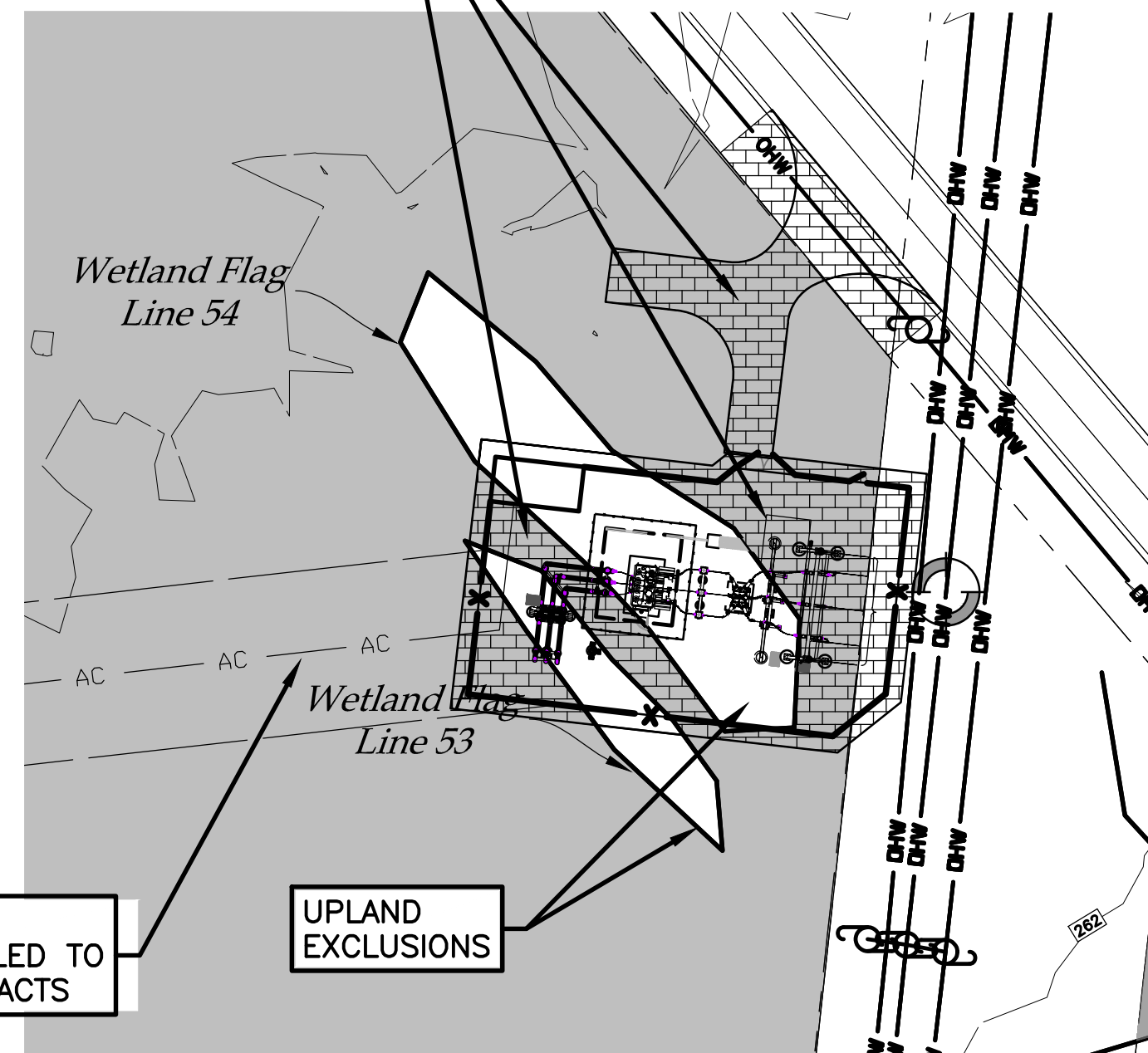
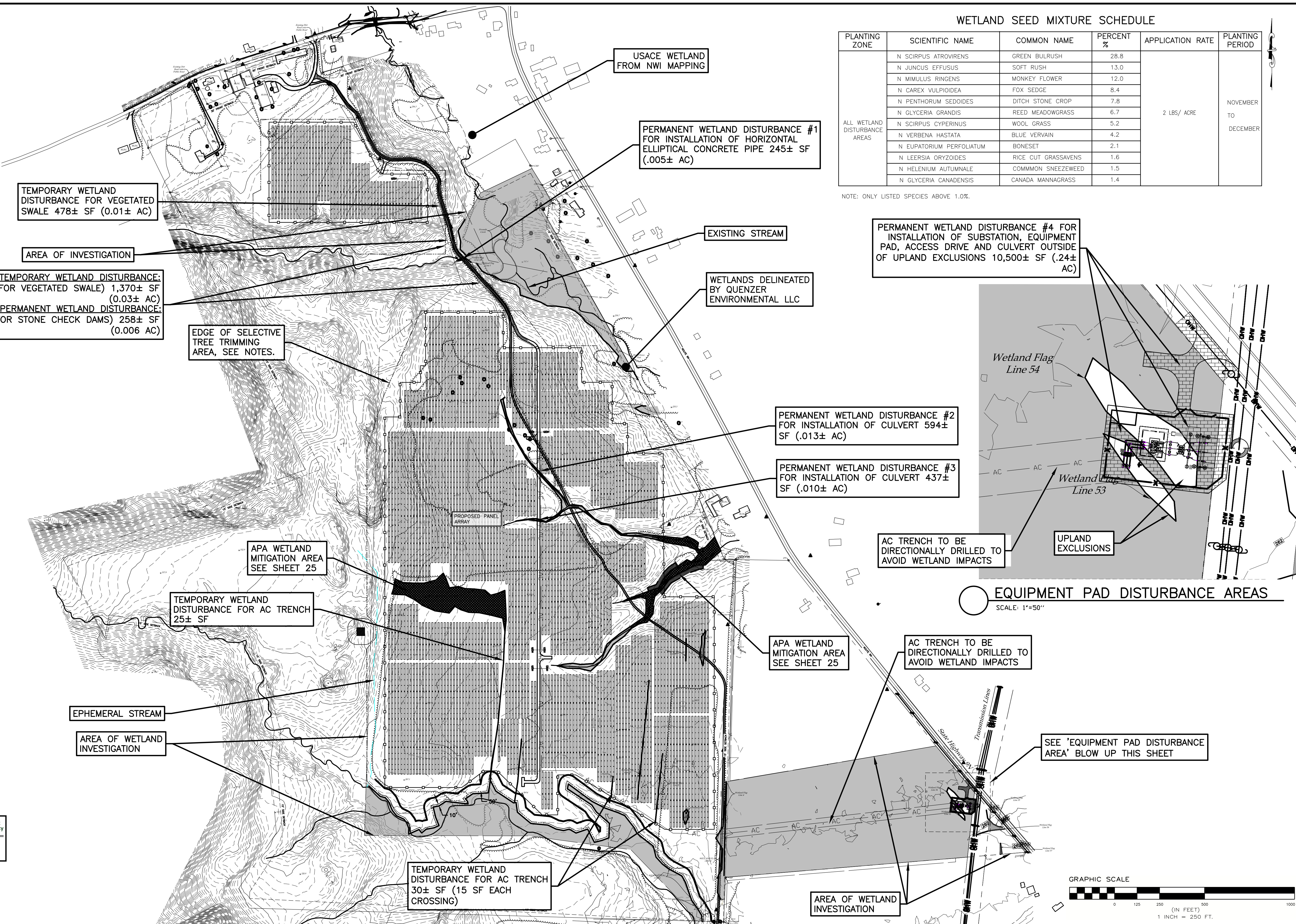

**EQUIPMENT PAD DISTURBANCE AREAS**  
 SCALE: 1"=50'

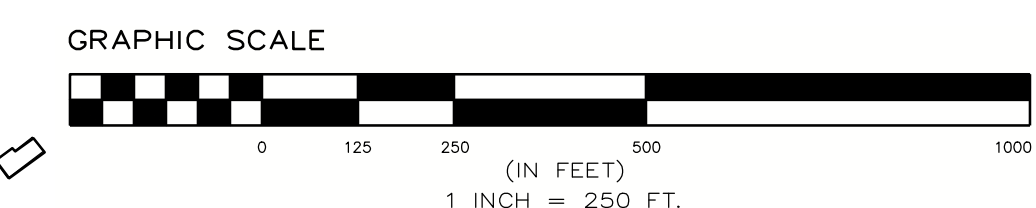

**SOLAR FIELD LAYOUT FOR ELP TICONDEROGA SOLAR**  
 APPLICANT: ELP TICONDEROGA SOLAR LLC  
 VETERANS ROAD  
 TOWN OF TICONDEROGA  
 ESSEX COUNTY, NEW YORK

JULY 15, 2020

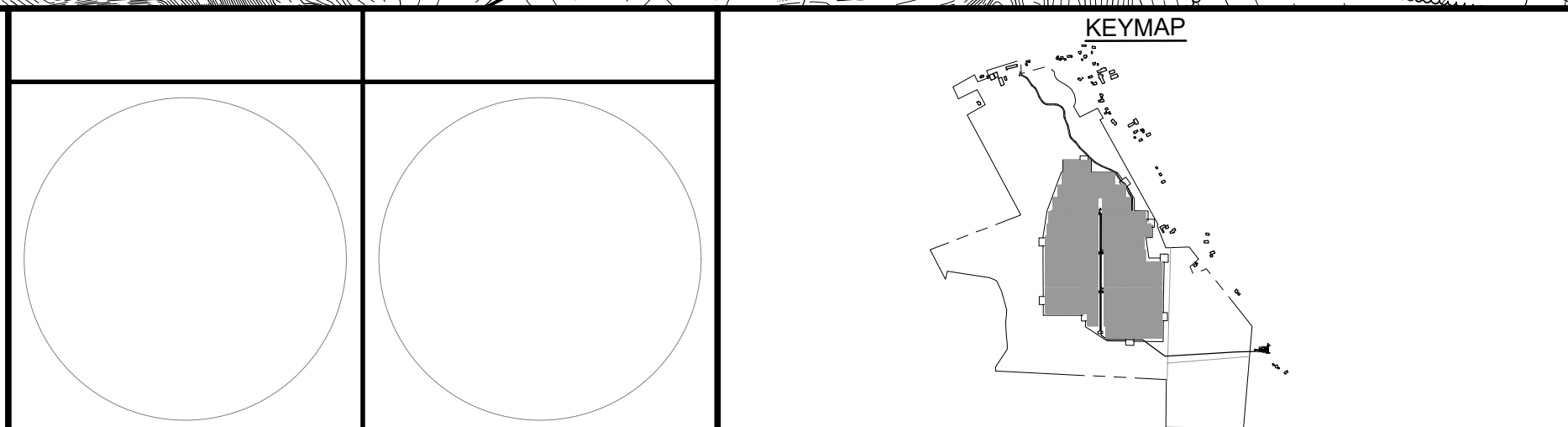

TOWN OF TICONDEROGA PLANNING BOARD APPROVAL  
 APPROVED BY RESOLUTION OF THE PLANNING BOARD OF THE TOWN OF TICONDEROGA, NEW YORK, ON THE \_\_\_\_\_ DAY OF \_\_\_\_\_ 20\_\_\_\_ SUBJECT TO ALL REQUIREMENTS AND CONDITIONS OF SAID RESOLUTION. ANY CHANGES, ERASURES, MODIFICATIONS OR REVISIONS OF THIS PLAT, AS APPROVED, SHALL VOID THIS APPROVAL.  
 SIGNED THE \_\_\_\_\_ DAY OF \_\_\_\_\_, 20\_\_\_\_ BY \_\_\_\_\_  
 PLANNING BOARD CHAIRMAN

REVISION	DATE	BY
REVISED PER APA COMMENT LETTER	10/23/20	BPO
REVISED TO SUBSTATION LAYOUT PER NATIONAL GRID	11/4/20	BPO
REVISED TO WETLAND FLAG PER ADIRONDACK PARK AGENCY COMMENTS	02/08/21	BPO
REVISED TO NATIONAL GRID COMMENTS	02/18/21	BPO
REVISED LAYOUT PLAN	04/27/21	BPO
UPDATES WETLAND DELINEATION	05/26/21	BPO
REVISED SUBSTATION LOCATION	07/26/21	BPO
REVISED SUBSTATION LAYOUT, WETLAND REVISIONS	08/31/21	BPO

**edp**  
**ENVIRONMENTAL DESIGN PARTNERSHIP, LLP.**  
 900 Route 146, Clifton Park, New York 12065  
 (518) 371-7621  
 edpllp.com

SHEET TITLE:  
**WETLAND IMPACTS PLAN**  
 SHEET:  
**23 of 29**  
 SCALE: 1" = 250'



**SITE STATISTICS**

PARCEL ZONING: LIGHT INDUSTRIAL  
 SOLAR FACILITY: TIER III GROUND MOUNTED  
 TAX PARCEL NO.: 139.4-1-1.110  
 PARCEL SIZE: 254.99 ACRES

**WETLAND DELINEATION NOTES:**

1. WETLAND DELINEATION PERFORMED BY QUENZER ENVIRONMENTAL WETLAND DELINEATION COMPLETED ON SEPTEMBER 30, 2019 AND WAS VERIFIED BY MS. MARY O'DELL OF THE ADIRONDACK PARK AGENCY. WETLANDS FLAGGING SURVEYED BY DARRAH LAND SURVEYING, PLLC.

**CONSTRUCTION WITHIN WATERS OF THE UNITED STATES AREAS NOTES:**

1. LOW GROUND PRESSURE CONSTRUCTION VEHICLES (6 PSI OR LESS) WILL BE UTILIZED IN ALL AREAS CONTAINING WATERS OF THE UNITED STATES (WOTUS).
2. WHEN INSTALLING RACKING POSTS WITHIN WOTUS AREAS:
  - 2.1. CONTRACTOR WILL MONITOR SITE CONDITIONS DAILY.
  - 2.2. CONTRACTOR WILL REFRAIN FROM MOVING TRACK MACHINERY INTO WOTUS AREAS DURING THE WET SEASON (APRIL 1ST - JUNE 1ST).
  - 2.3. ALL RACKING POSTS SHALL BE POUNDED/VIBRATED INTO PLACE TO THE REQUIRED EMBEDMENT DEPTH IN ACCORDANCE WITH THE RACKING SYSTEM MANUFACTURER'S GUIDELINES. NO EXCAVATION IS ALLOWED TO SUPPORT RACKING INSTALLATION IN WOTUS AREAS. ADDITIONALLY:
    - 2.3.1. CONTRACTOR WILL PROVIDE EXTRA MANPOWER TO SAFELY UNLOAD AND STAGE RACKING POSTS IN A MANNER WHERE NO TURNS WILL BE MADE BY LOW GROUND PRESSURE EQUIPMENT WITHIN WOTUS AREAS.
    - 2.3.2. CONTRACTOR WILL DEPLOY TRACK-MOUNTED POST DRIVERS IN A MANNER WHERE NO TURNS BE MADE IN WOTUS AREA WHILE POSTS ARE POUNDED/VIBRATED INTO PLACE.

3. CONTRACTOR SHALL UTILIZE ALTERNATIVE WIRE MANAGEMENT METHODS WHERE ALL WIRING IS SUPPORTED BY THE RACKING TO AVOID TRENCHING IN THE WOTUS AREAS.
4. ALL OTHER ACTIVITIES NECESSARY TO SUPPORT CONSTRUCTION OF SOLAR PANEL EQUIPMENT IN WOTUS AREAS SHALL NOT USE MECHANIZED EQUIPMENT.
5. CONTRACTOR SHALL CONSTRUCT A COFFER DAM UPSTREAM OF THE CULVERT CROSSING LOCATION, AND THE OPEN TRENCH SHALL REMAIN DRY DURING THE INSTALLATION OF THE CULVERTS. CONTRACTOR TO FOLLOW THE WETLAND CROSSING DETAILS ON SHEETS 27 AND 28.
6. TREE-TRIMMING TO REDUCE SOLAR PANEL SHADING WITHIN THE WOTUS BUFFER AREAS WILL BE CONDUCTED BY HAND AND WASTE MATERIALS WILL BE REMOVED BY HAND. THERE WILL BE NO EARTH DISTURBANCE OR STUMP REMOVAL.
7. FENCE POSTS INSTALLED IN WOTUS AREAS WILL BE DRIVEN OR POUNDED INTO PLACE TO THE REQUIRED EMBEDMENT DEPTH. NO EXCAVATION IS ALLOWED TO SUPPORT FENCE INSTALLATION IN WOTUS AREAS.

**RESTORATION WITHIN WATERS OF THE UNITED STATES NOTES:**

1. THE WETLAND SEED MIXTURE SHALL BE USED IN ALL AREAS WHERE WETLANDS DISTURBANCE TAKES PLACE.
2. THE WETLAND SEED MIXTURE CAN BE SOWN BY HAND, WITH A HAND-HELD SPREADER, OR HYDRO-SEEDED ON LARGE OR HARD TO REACH SITES.
3. LIGHTLY RAKE TO INSURE GOOD SEED-TO-SOIL CONTACT.
4. SEEDING CAN TAKE PLACE ON FROZEN SOIL.
5. IF SPRING CONDITIONS ARE DRIER THAN USUAL WATERING MAY BE REQUIRED.
6. IF SOWING DURING THE SUMMER MONTHS SUPPLEMENTAL WATERING WILL LIKELY BE REQUIRED UNTIL GERMINATION.
7. A LIGHT MULCH OF CLEAN, WEED FREE STRAW IS RECOMMENDED.

**WILLOW CUTTINGS PLANTING NOTES:**

1. PLANT DURING THE DORMANT SEASON.
2. CUT 1 TO ONE-INCH DIAMETER PLANTS OR STEMS AND REMOVE ALL LATERAL BRANCHES.
3. CUT THE STEMS WITH A KNIFE OR PRUNING SHEARS INTO 12 TO 24-INCH LENGTHS.
4. MAKE A HORIZONTAL CUT ON THE END WHICH WILL REMAIN EXPOSED AND A 45° ANGLE CUT ON THE END TO BE PLANTED.
5. BUDS ON PLANT SHOULD FACE UP.
6. PUSH CUTTING DIRECTLY INTO SOIL OR PRODUCE A PILOT HOLE BY POUNDING A PIECE OF METAL REBAR INTO THE SOIL AND THEN PUSH THE CUTTING INTO THE HOLE.
7. PLANT SO THAT ONLY A FEW INCHES REMAIN EXPOSED.

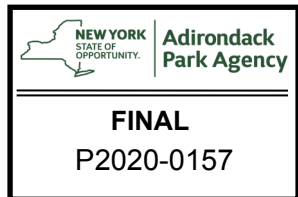

**SOLAR FIELD LAYOUT FOR**  
**ELP TICONDEROGA SOLAR**  
 APPLICANT: ELP TICONDEROGA SOLAR LLC  
 VETERANS ROAD  
 TOWN OF TICONDEROGA  
 ESSEX COUNTY, NEW YORK

JULY 15, 2020

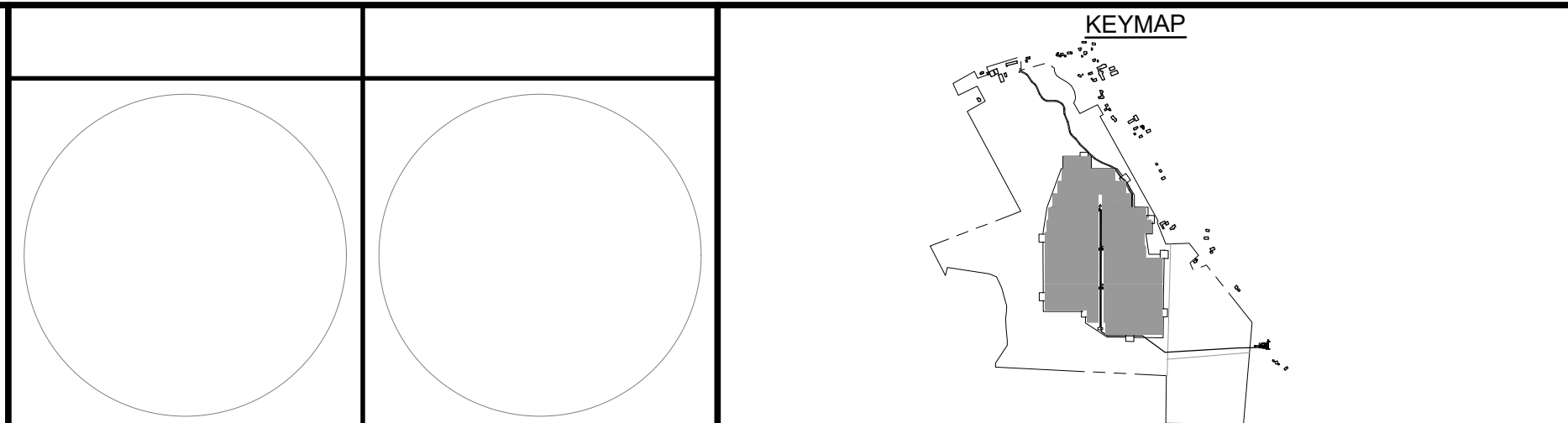

**TOWN OF TICONDEROGA PLANNING BOARD APPROVAL**

APPROVED BY RESOLUTION OF THE PLANNING BOARD OF THE TOWN OF TICONDEROGA, NEW YORK, ON THE \_\_\_\_\_ DAY OF \_\_\_\_\_, 20\_\_\_\_ SUBJECT TO ALL REQUIREMENTS AND CONDITIONS OF SAID RESOLUTION. ANY CHANGES, ERASURES, MODIFICATIONS OR REVISIONS OF THIS PLAT, AS APPROVED, SHALL VOID THIS APPROVAL.

SIGNED THE \_\_\_\_\_ DAY OF \_\_\_\_\_, 20\_\_\_\_ BY \_\_\_\_\_  
 PLANNING BOARD CHAIRMAN

REVISION	DATE	BY
REVISIONS PER AIA COMMENT LETTER	10/23/20	BPO
REVISIONS TO SUBSTATION LAYOUT PER NATIONAL GRID	11/4/20	BPO
REVISIONS TO WETLAND FLAG LINE PER NATIONAL GRID	02/08/21	BPO
REVISIONS PER NATIONAL GRID COMMENTS	02/18/21	BPO
REVISED LAYOUT PLAN	04/27/21	BPO
UPDATED WETLAND DELINEATION	05/26/21	BPO
REVISED SUBSTATION LOCATION	07/26/21	BPO
REVISED SUBSTATION LAYOUT, WETLAND REVISIONS	08/21/21	BPO

**edp**  
**ENVIRONMENTAL DESIGN PARTNERSHIP, LLP.**  
 900 Route 146, Clifton Park, New York 12065  
 (518) 371-7621  
 edplp.com

DESIGNED BY: [Signature] STD  
 CHECKED BY: [Signature] BPO  
 TOP PROJECT NUMBER: 12391  
 SHEET TITLE: **APA WETLAND MITIGATION PLAN**  
 SHEET: **24 of 29**  
 SCALE: 1" = 50'

**WETLAND SEED MIXTURE SCHEDULE**

PLANTING ZONE	SCIENTIFIC NAME	COMMON NAME	PERCENT %	APPLICATION RATE	PLANTING PERIOD
ALL WETLAND DISTURBANCE AREAS	N SCIRPUS ATROVIRENS	GREEN BULRUSH	28.8	2 LBS/ ACRE	NOVEMBER TO DECEMBER
	N JUNCUS EFFUSUS	SOFT RUSH	13.0		
	N MIMULUS RINGENS	MONKEY FLOWER	12.0		
	N CAREX VULPIDIEA	FOX SEDGE	8.4		
	N PENTHORUM SEDOIDES	DITCH STONE CROP	7.8		
	N GLYCERIA GRANDIS	REED MEADOWGRASS	6.7		
	N SCIRPUS CYPERINUS	WOOL GRASS	5.2		
	N VERBENA HASTATA	BLUE VERVAIN	4.2		
	N EUPATORIUM PERFOLIATUM	BONESET	2.1		
	N LEERSIA ORYZOIDES	RICE CUT GRASSAENS	1.6		
N HELENIUM AUTUMNALE	COMMON SNEEZEWEED	1.5			
N GLYCERIA CANADENSIS	CANADA MANNAGRASS	1.4			

NOTE: ONLY LISTED SPECIES ABOVE 1.0%.

**WETLAND PLANTINGS TABLE**

SCIENTIFIC NAME	COMMON NAME	PLANTINGS
CORNUS AMOMUM	SILKY DOGWOOD	450
SAMBUCUS CANADENSIS	ELDERBERRY	
ILEX VERTICILLATA	WINTERBERRY HOLLY	
SALIX DISCOLOR AND S. SERICEA	WILLOW	
VACCINIUM CORYMBOSUM	HIGHBUSH BLUEBERRY	

**BUFFER PLANTINGS TABLE**

SCIENTIFIC NAME	COMMON NAME	PLANTINGS
PINUS STROBUS	WHITE PINE	50
CORNUS RACEMOSE	GRAY DOGWOOD	

**NOTES:**

1. WETLAND AND BUFFER ENHANCEMENT AREAS WILL BE PLANTED IN THE SPRING OR FALL WITH 18 TO 36-INCH POTTED SHRUBS AND SAPLINGS ON A 15-FOOT MATRIX (A 175 WETLAND SPECIES AND 450 BUFFER SPECIES. PLANTING PATTERN FOR ALL SPECIES WILL BE DONE IN A RANDOM FASHION AS OPPOSED TO EVENLY SPACED ROWS).
2. THE WETLAND ENHANCEMENT AREA WILL BE SEEDED WITH 2 LBS. OF NORTHEAST WETLAND DIVERSITY MIX OR EQUIVALENT (1 POUND WILL COVER 21,750 SF @ 100+ SEEDS PER SF.)
3. THE UPLAND BUFFER ENHANCEMENT AREA WILL BE SEEDED WITH A POLLINATOR/WILDLIFE SEED MIX FOLLOWING INSTALLATION OF THE WOODY SPECIMENS. APPROXIMATELY TWO POUNDS OF XERCES MID-ATLANTIC POLLINATOR MIX OR EQUIVALENT WILL BE SEEDD IN THE RESTORATION AREAS.

**XERCES MID-ATLANTIC POLLINATOR SEED MIXTURE SCHEDULE**

PLANTING ZONE	SCIENTIFIC NAME	COMMON NAME	PERCENT %	APPLICATION RATE	PLANTING PERIOD
UPLAND BUFFER ENHANCEMENT AREAS	SCHIZACHYRIUM SCOPARIUM	LITTLE BLUESTEM, CAMPER	32.0	7 LBS/ ACRE	NOVEMBER TO DECEMBER
	ECHINACEA PURPUREA	PURPLE CONEFLOWER	15.0		
	VERBENA HASTATA	BLUE VERVAIN	10.4		
	COREOPSIS LANCEOLATA	LANCELEAF COREOPSIS	10.0		
	CHAMAECRISTA FASCICULATA	PARTRIDGE PEA	7.0		
	PENSTEMON LAEVIGATUS	APPALACHIN BEARTONGUE	7.0		
	ASCLEPIAS TUBEROSA	BUTTERFLY MILKWEED	4.0		
	LIATRIS SPICATA	MARSH BLAZING STAR	4.0		
	ASTER CORDIFOLIUS	BLUE WOOD ASTER	2.0		
	ASTER LATERIFLORUS	CALICO ASTER	2.0		
	BAPTISIA AUSTRALIS	BLUE FALSE INDIGO	2.0		
	GEUM CANADENSE	WHITE AVENS	1.0		
	RUDBECKIA FULGIDA	ORANGE CONEFLOWER	1.0		
	VERBESINA ALTERNIFOLIA	WINGSTEM	1.0		

NOTE: ONLY LISTED SPECIES ABOVE 1%.

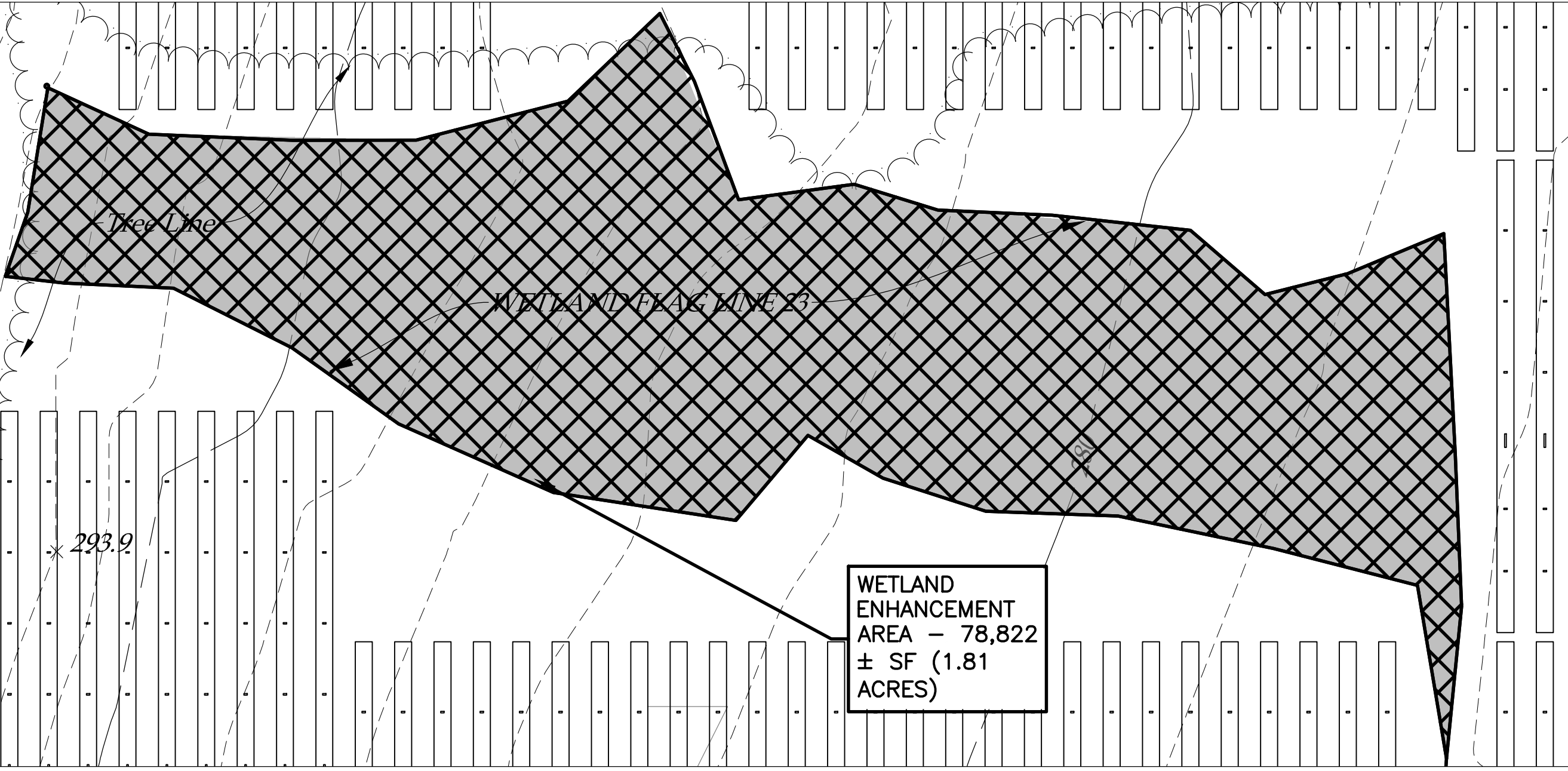
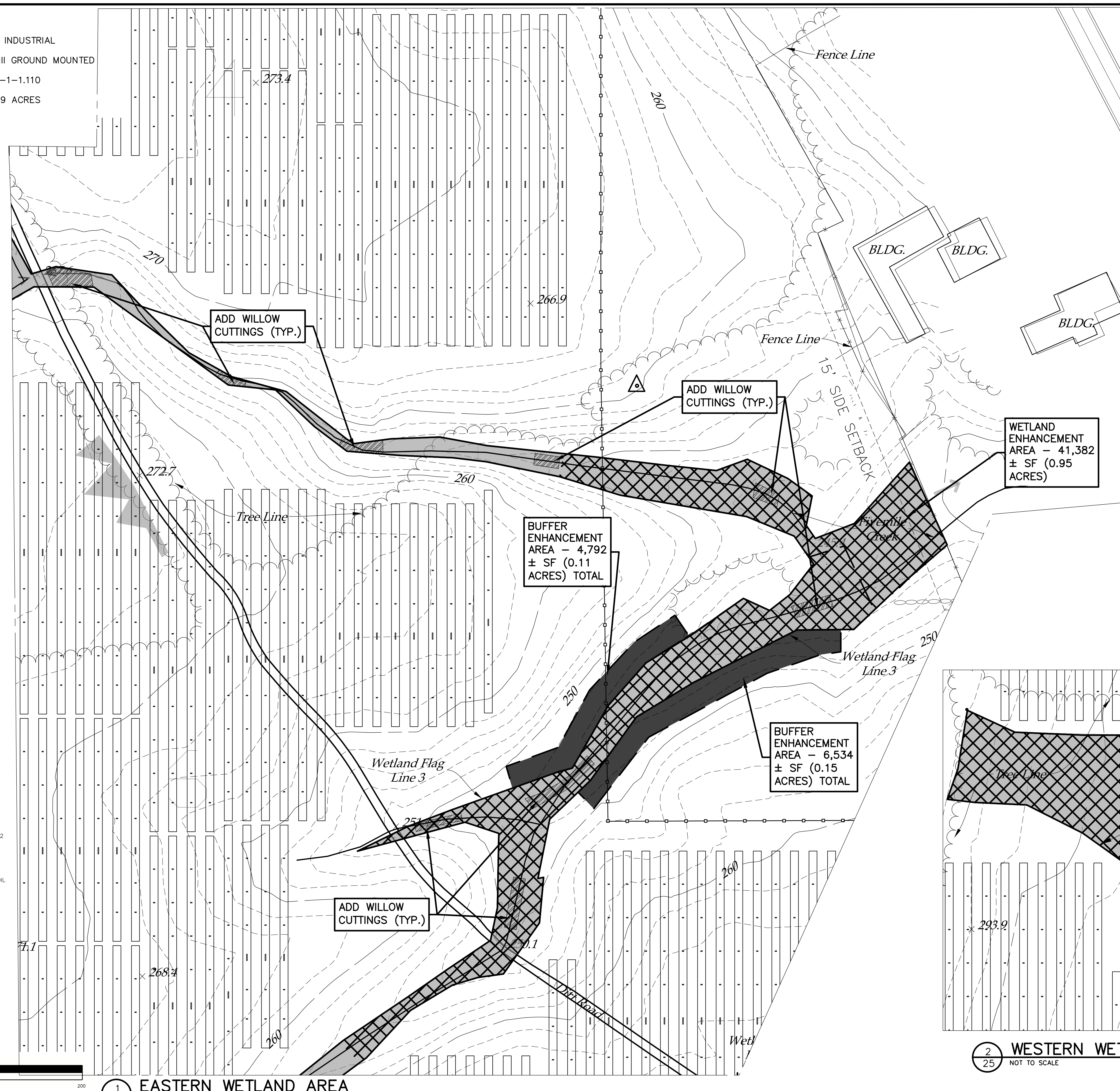

**2 WESTERN WETLAND AREA**  
 NOT TO SCALE

**1 EASTERN WETLAND AREA**  
 NOT TO SCALE



**REFERENCE PLANS:**

- EXISTING CONDITIONS AND PROPOSED ARRAY LAYOUT FROM "SOLAR FIELD LAYOUT" BY ENVIRONMENTAL DESIGN PARTNERSHIP, LLP DATED 04/15/2019, REVISED 10/15/2019

**UTILITY NOTES:**

- LOCATION OF UNDERGROUND UTILITIES IS NOT COMPLETE. CONTRACTOR RESPONSIBLE FOR LOCATING UNDERGROUND UTILITIES.
- CALL DIG-SAFE AT 1-800-DIG-SAFE PRIOR TO THE COMMENCEMENT OF ANY CONSTRUCTION ACTIVITY.

**LANDSCAPE NOTES**

- ALL PLANTS TO BE INSTALLED WITH CLEAN PLANTING MIX CONTAINING MINIMUM 30% ORGANIC MATTER, FREE OF STONES, WEEDS AND DELETERIOUS MATTER.
- PROVIDE MINIMUM 3 TIMES EXISTING ROOTBALL VOLUME OF APPROVED PLANTING MIX.
- PROVIDE 3" DOUBLE GROUND, NATURAL BARK MULCH
- STAKE AS NECESSARY.
- ALL LAWN AREAS DISTURBED DURING PLANTING SHALL BE RESTORED WITH CLEAN TOPSOIL, SEED AND STRAW MULCH, MIN. 3/4" THICK

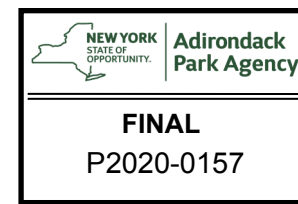

**SEEDING AND MULCHING NOTES**

- CLEAR AND GRADE THE PROPOSED AREA OF DISTURBANCE.
- INSTALL AND MAINTAIN ALL EROSION AND SEDIMENT CONTROL MEASURES THROUGHOUT THE COURSE OF CONSTRUCTION.
- WHEN ALL DISTURBED AREAS ARE STABLE, REMOVE ALL TEMPORARY EROSION AND SEDIMENT CONTROL MEASURES.
- TEMPORARY EROSION CONTROL PROTECTION BY MULCHING MUST BE CARRIED OUT AS THE FILL IS PROGRESSED TO AVOID ALL POSSIBLE CONTAMINATION OF PONDS, STREAMS, OR OTHER WATERCOURSES. PLACEMENT OF JUTE MESH OVER THE MULCH IS RECOMMENDED TO PROVIDE POSITIVE "TACKING" OF THE MULCH AND INCREASED PROTECTION AGAINST EROSION.
- PLAN SITE PREPARATION ACTIVITIES TO MINIMIZE THE SCOPE AND DURATION OF SOIL DISRUPTION.
- IF EXISTING SUITABLE TOPSOIL IS NOT ALREADY IN PLACE, TOPSOIL IS TO BE PLACED TO A MINIMUM UNIFORM DEPTH OF 4" OVER THE APPLICATION AREA. DO NOT PLACE WHEN IT IS PARTIALLY FROZEN, MUDDY, ON FROZEN SLOPES OR OVER ICE, SNOW OR STANDING WATER.
- TOPSOIL, WHETHER EXISTING OR IMPORTED, SHALL CONSIST OF NATURAL LOAM TOPSOIL FREE OF COBBLES, CLAY, SAND AND OTHER UNSUITABLE MATERIALS.
- CONTRACTOR SHALL BE RESPONSIBLE FOR WATERING, FERTILIZING, MULCHING, ETC. TO ESTABLISH GROWTH AND MAINTAIN SEEDED AREAS UNTIL ACCEPTED BY THE OWNER.
- CONTRACTOR SHALL COMPLY WITH ALL SWPPP REQUIREMENTS.
- INSPECT THE PROJECT SITE AND ALL EROSION AND SEDIMENT CONTROL PRACTICES AFTER EACH RAIN EVENT AND ON A WEEKLY BASIS IN ACCORDANCE WITH THE PROJECT SPECIFIC SWPPP.
- REPAIR AND REMEDY ANY EROSION AND SEDIMENT CONTROL PRACTICES OBSERVED TO BE DEFICIENT OR IN NEED OF REPAIR OR AT THE DIRECTION OF THE DIRECTOR'S REPRESENTATIVE.
- IMPLEMENT AND COMPLY WITH ALL THE PROJECT-SPECIFIC SWPPP REQUIREMENTS.
- STABILIZE DISTURBED AREAS IMMEDIATELY BUT NOT MORE THAN SEVEN DAYS AFTER SOIL DISTURBANCE HAS CEASED.
- ALL AREAS WITHIN THE FENCE LINE AND ALL DISTURBED AREAS OUTSIDE THE FENCE LINE, INCLUDING TEMPORARY LAYDOWN AREAS, WILL BE SEEDED AND RESTORED.

ELP  
TICONDEROGA

PREPARED FOR:  
EAST LIGHT PARTNERS  
CAMBRIDGE, MA

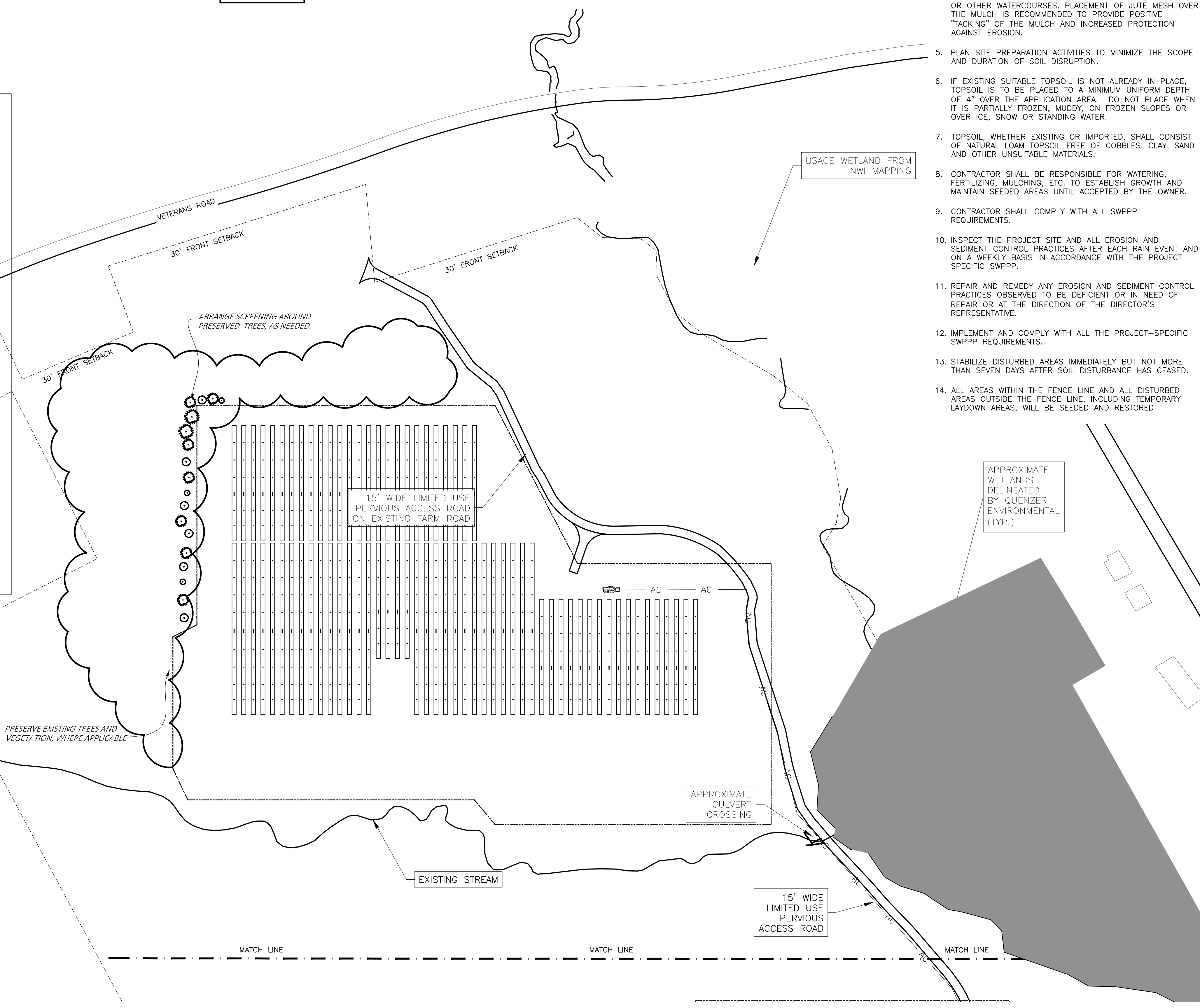
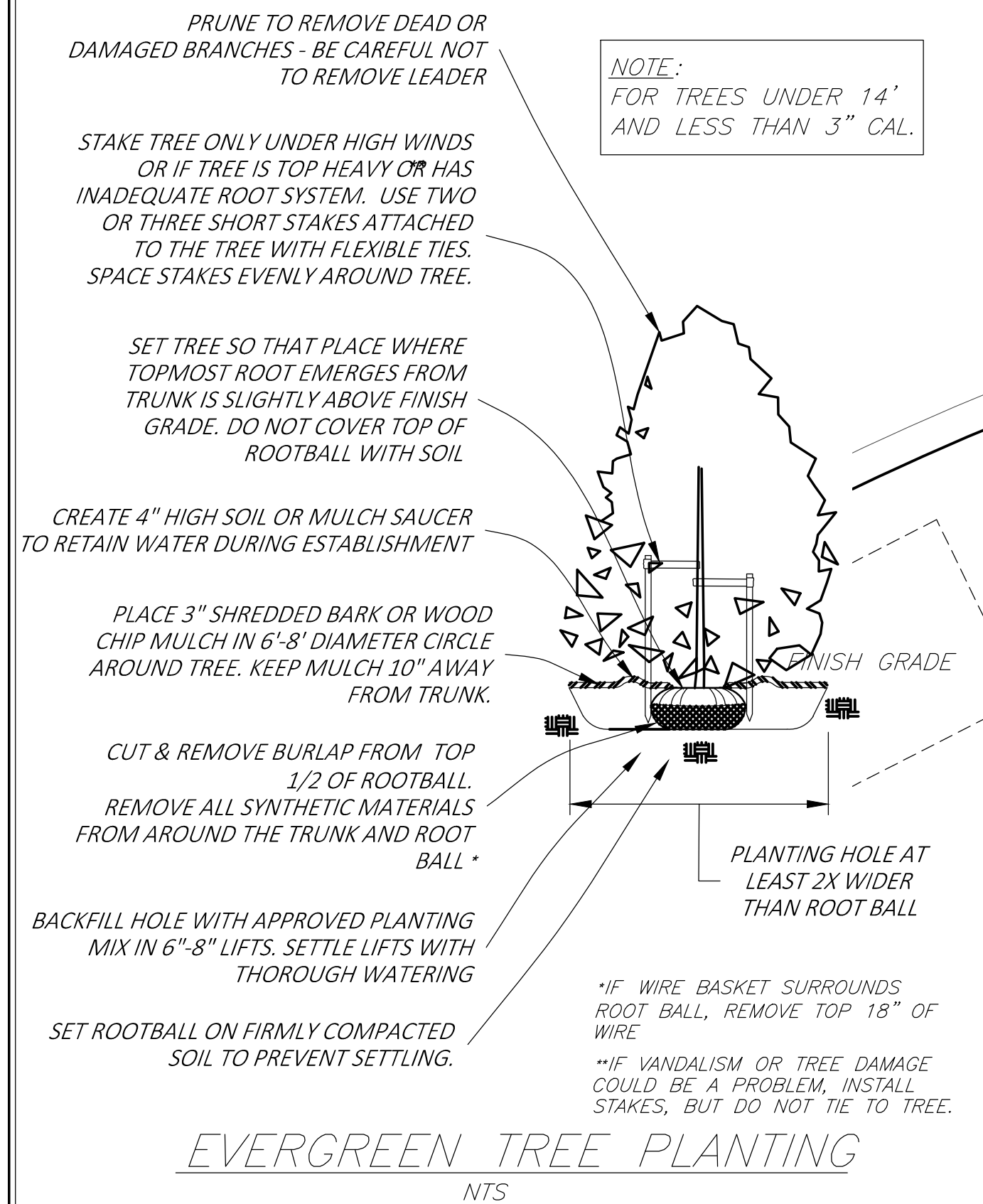

**WILDFLOWER/RESTORATION SEED MIXTURE SCHEDULE**

SCIENTIFIC NAME	COMMON NAME	INDICATOR STATUS	% BY NUMBER OF SEEDS	APPLICATION RATE
NORTHEAST SOLAR POLLINATOR 3' MIX - ERNMx-612 (IN SUNLIGHT AREAS)				
FESTUCA OVINA	SHEEP FESCUE	N/A	94.90	40 LBS/43,560 SF
ASCLEPIAS TUBEROSA	BUTTERFLY MILKWEED	N/A	2.5	40 LBS/43,560 SF
CHAMAECRISTA, PA ECOTYPE	PARTRIDGE PEA, PA ECOTYPE	N/A	2.0	40 LBS/43,560 SF
GENOTHERA FRUTICOSA VAR. FRUTICOSA	SUNDROPS	N/A	0.3	40 LBS/43,560 SF
TRIDESCANIA VIRGINIANA, SOUTHEASTERN PA / NORTHERN VA	VIRGINIA SPIDERWORT, SOUTHEASTERN PA / NORTHERN VA BLEND	N/A	0.3	40 LBS/43,560 SF
PLANTING PERIOD				
APRIL 15-JUNE 15				
SEPTEMBER 15-OCTOBER 15				

PURPOSE OF DRAWING:  
DRAFT CONCEPT  
FOR CLIENT REVIEW  
MAY 28, 2020  
NOT FOR CONSTRUCTION

**LANDSCAPING PLAN**

REVISION  
REVISED SEED MIX AND PLANTINGS  
10/23/2020

PREPARED BY:  
HUBBARD LAND DESIGN  
E. ADAM HUBBARD, RLA  
492 BEEBE RD.  
PUTNEY, VT 05346  
802-380-5875  
Adam@HubbardLandDesign.com

SCALE 1"=100' @ 24x36"  
DATE 05/28/2020  
PAGE L-2  
SHEET 25 of 29



**SEEDING AND MULCHING NOTES**

1. CLEAR AND GRADE THE PROPOSED AREA OF DISTURBANCE.
2. INSTALL AND MAINTAIN ALL EROSION AND SEDIMENT CONTROL MEASURES THROUGHOUT THE COURSE OF CONSTRUCTION.
3. WHEN ALL DISTURBED AREAS ARE STABLE, REMOVE ALL TEMPORARY EROSION AND SEDIMENT CONTROL MEASURES.
4. TEMPORARY EROSION CONTROL PROTECTION BY MULCHING MUST BE CARRIED OUT AS THE FILL IS PROGRESSED TO AVOID ALL POSSIBLE CONTAMINATION OF PONDS, STREAMS, OR OTHER WATERCOURSES. PLACEMENT OF JUTE MESH OVER THE MULCH IS RECOMMENDED TO PROVIDE POSITIVE "TACKING" OF THE MULCH AND INCREASED PROTECTION AGAINST EROSION.
5. PLAN SITE PREPARATION ACTIVITIES TO MINIMIZE THE SCOPE AND DURATION OF SOIL DISRUPTION.
6. IF EXISTING SUITABLE TOPSOIL IS NOT ALREADY IN PLACE, TOPSOIL IS TO BE PLACED TO A MINIMUM UNIFORM DEPTH OF 4" OVER THE APPLICATION AREA. DO NOT PLACE WHEN IT IS PARTIALLY FROZEN, MUDDY, ON FROZEN SLOPES OR OVER ICE, SNOW OR STANDING WATER.
7. TOPSOIL, WHETHER EXISTING OR IMPORTED, SHALL CONSIST OF NATURAL LOAM TOPSOIL FREE OF COBBLES, CLAY, SAND AND OTHER UNSUITABLE MATERIALS.
8. CONTRACTOR SHALL BE RESPONSIBLE FOR WATERING, FERTILIZING, MULCHING, ETC. TO ESTABLISH GROWTH AND MAINTAIN SEEDING AREAS UNTIL ACCEPTED BY THE OWNER.
9. CONTRACTOR SHALL COMPLY WITH ALL SWPPP REQUIREMENTS.
10. INSPECT THE PROJECT SITE AND ALL EROSION AND SEDIMENT CONTROL PRACTICES AFTER EACH RAIN EVENT AND ON A WEEKLY BASIS IN ACCORDANCE WITH THE PROJECT SPECIFIC SWPPP.
11. REPAIR AND REMEDY ANY EROSION AND SEDIMENT CONTROL PRACTICES OBSERVED TO BE DEFICIENT OR IN NEED OF REPAIR OR AT THE DIRECTION OF THE DIRECTOR'S REPRESENTATIVE.
12. IMPLEMENT AND COMPLY WITH ALL THE PROJECT-SPECIFIC SWPPP REQUIREMENTS.
13. STABILIZE DISTURBED AREAS IMMEDIATELY BUT NOT MORE THAN SEVEN DAYS AFTER SOIL DISTURBANCE HAS CEASED.
14. ALL AREAS WITHIN THE FENCE LINE AND ALL DISTURBED AREAS OUTSIDE THE FENCE LINE, INCLUDING TEMPORARY LAYDOWN AREAS, WILL BE SEEDED AND RESTORED.

**REFERENCE PLANS:**

1. EXISTING CONDITIONS AND PROPOSED ARRAY LAYOUT FROM "SOLAR FIELD LAYOUT" BY ENVIRONMENTAL DESIGN PARTNERSHIP, LLP DATED 04/15/2019, REVISED 10/15/2019

**UTILITY NOTES:**

1. LOCATION OF UNDERGROUND UTILITIES IS NOT COMPLETE. CONTRACTOR RESPONSIBLE FOR LOCATING UNDERGROUND UTILITIES.
2. CALL DIG-SAFE AT 1-800-DIG-SAFE PRIOR TO THE COMMENCEMENT OF ANY CONSTRUCTION ACTIVITY.

**LANDSCAPE NOTES**

1. ALL PLANTS TO BE INSTALLED WITH CLEAN PLANTING MIX CONTAINING MINIMUM 30% ORGANIC MATTER. FREE OF STONES, WEEDS AND DELETERIOUS MATTER.
2. PROVIDE MINIMUM 3 TIMES EXISTING ROOTBALL VOLUME OF APPROVED PLANTING MIX.
3. PROVIDE 3" DOUBLE GROUND, NATURAL BARK MULCH
4. STAKE AS NECESSARY.
5. ALL LAWN AREAS DISTURBED DURING PLANTING SHALL BE RESTORED WITH CLEAN TOPSOIL, SEED AND STRAW MULCH, MIN. 3/4" THICK

**EVERGREEN TREE PLANTING**

NTS

PRUNE TO REMOVE DEAD OR DAMAGED BRANCHES - BE CAREFUL NOT TO REMOVE LEADER

STAKE TREE ONLY UNDER HIGH WINDS OR IF TREE IS TOP HEAVY OR HAS INADEQUATE ROOT SYSTEM. USE TWO OR THREE SHORT STAKES ATTACHED TO THE TREE WITH FLEXIBLE TIES. SPACE STAKES EVENLY AROUND TREE.

SET TREE SO THAT PLACE WHERE TOPMOST ROOT EMERGES FROM TRUNK IS SLIGHTLY ABOVE FINISH GRADE. DO NOT COVER TOP OF ROOTBALL WITH SOIL

CREATE 4" HIGH SOIL OR MULCH SAUCER TO RETAIN WATER DURING ESTABLISHMENT

PLACE 3" SHREDDED BARK OR WOOD CHIP MULCH IN 6"-8" DIAMETER CIRCLE AROUND TREE. KEEP MULCH 10" AWAY FROM TRUNK.

CUT & REMOVE BURLAP FROM TOP 1/2 OF ROOTBALL. REMOVE ALL SYNTHETIC MATERIALS FROM AROUND THE TRUNK AND ROOT BALL.

BACKFILL HOLE WITH APPROVED PLANTING MIX IN 6"-8" LIFTS. SETTLE LIFTS WITH THOROUGH WATERING

SET ROOTBALL ON FIRMLY COMPACTED SOIL TO PREVENT SETTLING.

NOTE: FOR TREES UNDER 14' AND LESS THAN 3" CAL.

\*IF WIRE BASKET SURROUNDS ROOT BALL, REMOVE TOP 18" OF WIRE

\*\*IF VANDALISM OR TREE DAMAGE COULD BE A PROBLEM, INSTALL STAKES, BUT DO NOT TIE TO TREE.

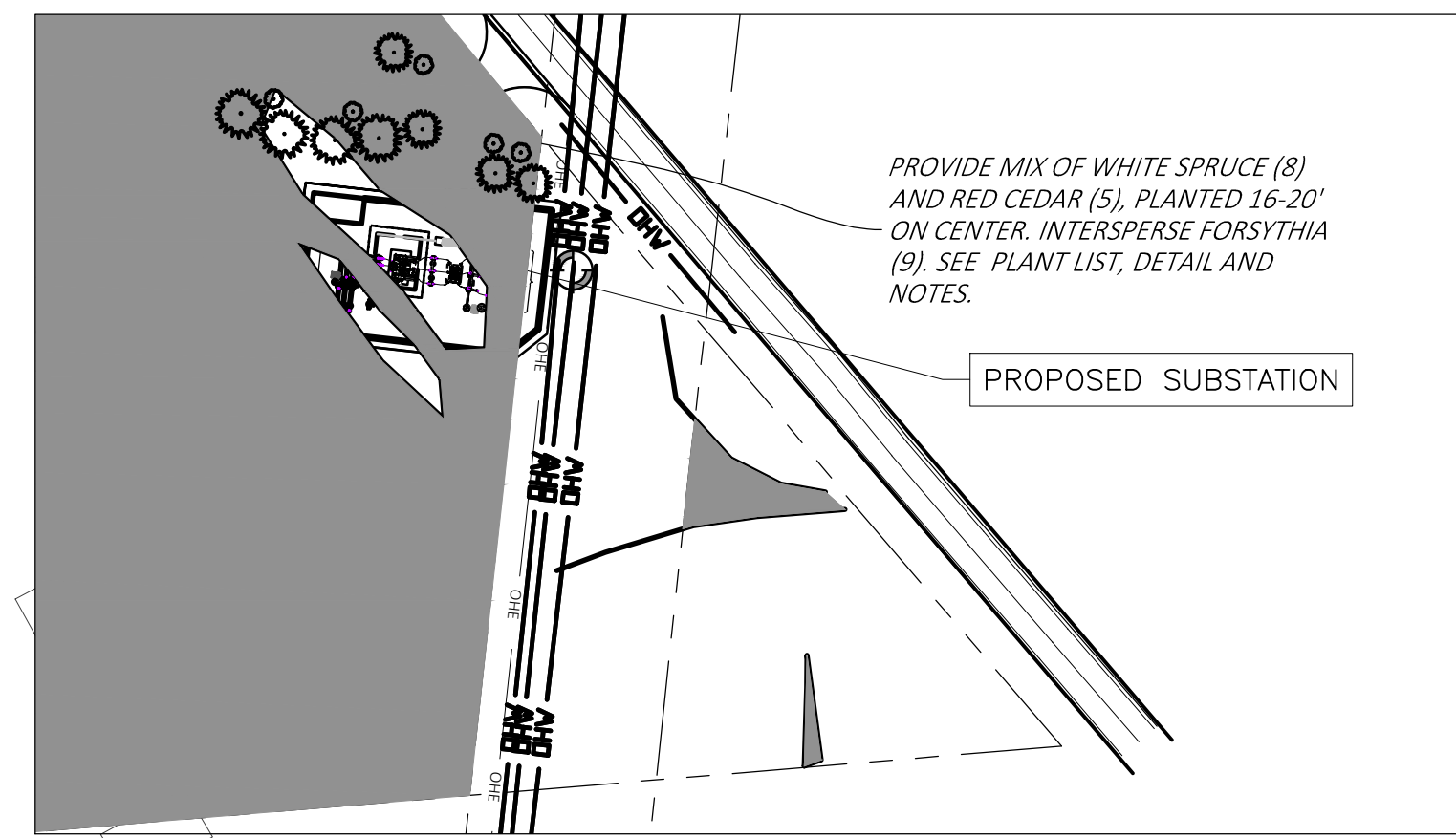
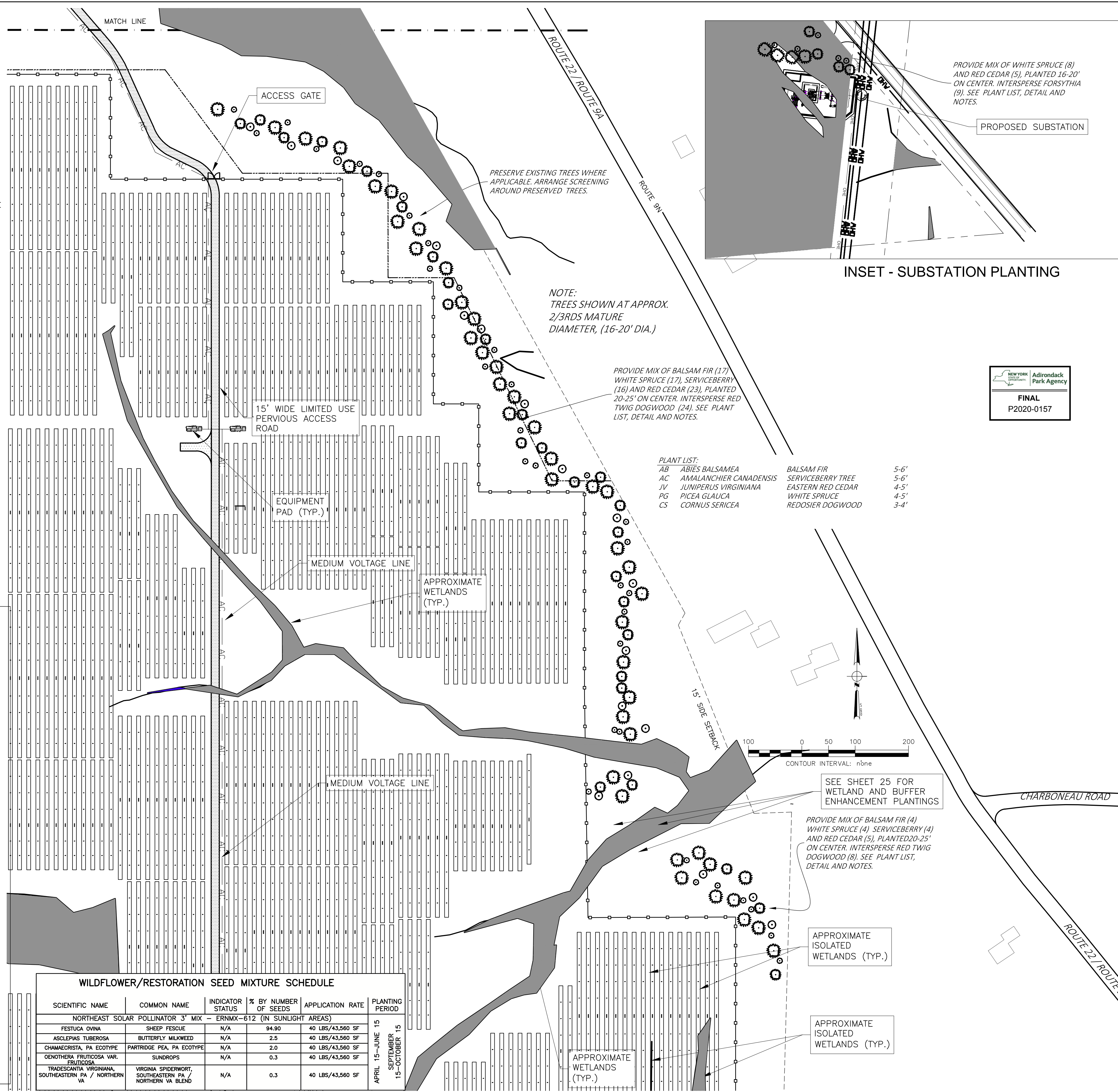

NOTE: TREES SHOWN AT APPROX. 2/3RDS MATURE DIAMETER, (16-20' DIA.)

PROVIDE MIX OF BALSAM FIR (17), WHITE SPRUCE (17), SERVICEBERRY (16) AND RED CEDAR (23), PLANTED 20-25' ON CENTER. INTERSPERSE RED TWIG DOGWOOD (24). SEE PLANT LIST, DETAIL AND NOTES.

**PLANT LIST:**

AB	ABIES BALSAMEA	BALSAM FIR	5-6'
AC	AMALANCHIER CANADENSIS	SERVICEBERRY TREE	5-6'
JV	JUNIPERUS VIRGINIANA	EASTERN RED CEDAR	4-5'
PG	PICEA GLAUCA	WHITE SPRUCE	4-5'
CS	CORNUS SERICEA	REDOSIER DOGWOOD	3-4'

Adirondack Park Agency  
FINAL  
P2020-0157

**WILDFLOWER/RESTORATION SEED MIXTURE SCHEDULE**

SCIENTIFIC NAME	COMMON NAME	INDICATOR STATUS	% BY NUMBER OF SEEDS	APPLICATION RATE	PLANTING PERIOD
NORTHEAST SOLAR POLLINATOR 3' MIX - ERNMX-612 (IN SUNLIGHT AREAS)					
FESTUCA OVINA	SHEEP FESCUE	N/A	84.90	40 LBS/43,560 SF	APRIL 15 - JUNE 15
ASCLEPIAS TUBEROSA	BUTTERFLY MILKWEED	N/A	2.5	40 LBS/43,560 SF	SEPTEMBER 15 - OCTOBER 15
CHAMAECRISTA PA ECOTYPE	PARRIDGE PEA, PA ECOTYPE	N/A	2.0	40 LBS/43,560 SF	
OENOTHERA FRUITICOSA VAR. FRUITICOSA	SUNDRIPS	N/A	0.3	40 LBS/43,560 SF	
TRIDASCANTHA VIRGINIANA, SOUTHEASTERN PA / NORTHERN VA	VIRGINIA SPIDERWORT, SOUTHEASTERN PA / NORTHERN VA BLEND	N/A	0.3	40 LBS/43,560 SF	

ELP  
TICONDEROGA

PREPARED FOR:  
EAST LIGHT PARTNERS  
CAMBRIDGE, MA

PURPOSE OF DRAWING:  
DRAFT CONCEPT  
FOR CLIENT REVIEW  
MAY 28, 2020  
NOT FOR CONSTRUCTION

**LANDSCAPING PLAN**

REVISION  
REVISED SEED MIX AND PLANTINGS  
10/23/2020

PREPARED BY:  
HUBBARD LAND DESIGN  
E. ADAM HUBBARD, RLA  
492 BEEBE RD.  
PUTNEY, VT 05346  
802-380-5875  
Adam@HubbardLandDesign.com

SCALE 1"=100' @ 24x36"  
DATE 05-25-2020  
PAGE L-3  
SHEET 26 of 29