

THIS IS A TWO-SIDED DOCUMENT



**Adirondack
Park Agency**

PO Box 99 · 1133 NYS Route 86
Ray Brook, NY 12977
Tel: (518) 891-4050
www.apa.ny.gov

**APA General
Permit/Order
2019G-1**

Permit #: 2025-0009

**Certification for the Replacement
of Certain Utility Poles**

This certification under General Permit 2019G-1 is granted to National Grid, authorizing the replacement of utility poles as described herein in the Town of Duane, Franklin County.

All terms and conditions of this certification shall apply to the applicant and any individual, contractor, municipality, or other entity undertaking the authorized work on the project site.

This certification does not grant any right to trespass upon the lands or interfere with the riparian rights of others, nor does it authorize the impairment of any easement, right, title, or interest in real or personal property.

Nothing contained in this certification shall be construed to satisfy any legal obligations of the applicant to comply with all applicable laws and regulations or to obtain any governmental approval or permit from any entity other than the Agency, whether federal, state, regional, or local.

PROJECT DESCRIPTION AS PROPOSED

The project as conditionally approved herein involves the replacement of four existing utility poles ranging from 34 feet to 39 feet above grade with four new utility poles with an overall height of 43 feet above grade.

The project is shown on a six-sheet set of plans titled, "National Grid 27-24-30946933," dated April 5, 2024, and received by the Agency on January 9, 2025.

Reduced-scale copies of these plans are attached to this certificate for easy reference. The original, full-scale maps and plans described in this paragraph are the official plans for the project, with copies available upon request from Adirondack Park Agency headquarters in Ray Brook, New York.

CONDITIONS

1. The height and location of the replacement utility poles and any associated vegetative cutting and maintenance shall comply with all applicable utility laws, regulations, safety requirements, and company specifications.
2. For projects involving wetlands:
 - a. Whenever practicable, access through wetlands shall occur on frozen ground and with the use of wide-tracked vehicles.

- b. All activities shall occur in compliance with the "Best Management Practice for Preventing the Transportation of Invasive Plant Species," published by Environmental Energy Alliance of New York, 4/26/2012.
 - c. No temporary access structure, including bog mats and work pads, shall be located within a wetland for more than 30 days.
 - d. Existing poles to be replaced shall be removed completely from the wetland, including the portion of the pole that was below grade.
 - e. If any hole left after removal of a pole or created for a replacement pole is to be backfilled with gravel or other ballast, the top six inches shall be covered with organic soil and the final elevation shall be the same as the surrounding wetland surface.
 - f. The total area of wetland disturbance shall be limited to that necessary for replacement of the utility poles.
3. When brought from off-site, all vehicles, construction equipment, and hand excavation tools to be used on the project site shall be clean and free of soil, mud, or other similar material. If washed on the project site, equipment shall be washed in one location to prevent the distribution of propagules among different wash sites. All vehicles, construction equipment, and hand excavation tools used in areas that may contain existing invasive species shall be thoroughly cleaned prior to moving to other areas.
 4. The Agency may conduct on-site investigations, examinations, and evaluations as it deems necessary to ensure compliance with the terms and conditions of this certification.

CERTIFICATION issued this 5th day
of February, 2025.

ADIRONDACK PARK AGENCY

BY: Ariel Lynch
Ariel Lynch
Environmental Program Specialist 3 (EPS3)

STATE OF NEW YORK
COUNTY OF ESSEX

On the 5th day of February in the year 2025, before me, the undersigned, a Notary Public in and for said State, personally appeared Ariel Lynch, personally known to me or proved to me on the basis of satisfactory evidence to be the individual whose name is subscribed to the within instrument and acknowledged to me that they executed the same in their capacity, and that by their signature on the instrument, the individual, or the person upon behalf of which the individual acted, executed the instrument.

Stephanie L. Petith
Notary Public

Stephanie L. Petith
Notary Public, State of New York
Reg No 01PE6279890
Qualified in Franklin County
Commission Expires April 15, 2025

NEW YORK STATE
Adirondack
Park Agency
RECEIVED
Date: January 9, 2025

NEW YORK STATE
Adirondack
Park Agency
FINAL
P2025-0009

VERIZON JOINT POLE PROPOSAL
STATE HWY 30 DUANE NY
WR 30946933
4.8KV, FDR 85251
TEL SETTING 4 NEW POLES
TRANSFERRING OVER EQUIPMENT
REPLACING XFMR ON POLE 315
MAY NEED FLAGGING

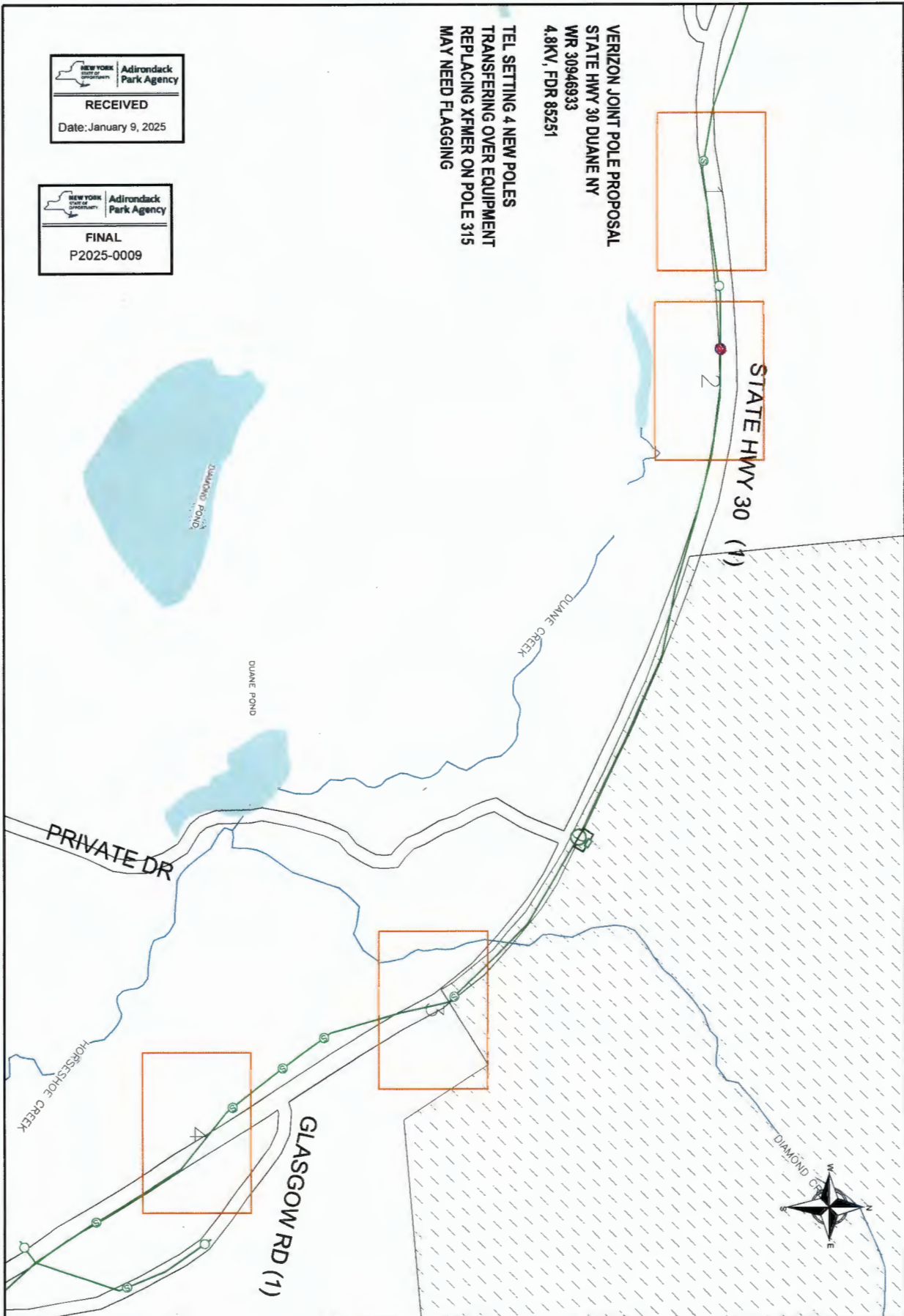

NATIONAL GRID USA		27-24-30946933		0 413 826 FT	
WORK REQUEST: 27-24-30946933	DESCRIPTION:	<input type="checkbox"/> BUILT AS DESIGNED	T.D./T.C. 6333	<input type="checkbox"/> MAINLINE MAP/VOLTAGE CONVERSIONS UPDATE REQUIRED	
STORMS ORDER: 30946933 DATE: 04/06/2024	verizon is replacing 4 poles on state hwy 30 in duane. need to transfer national grid equipment/lin	<input type="checkbox"/> AS BUILT CHANGES	FEEDER NO. 85251		
DESIGNER: Rosenbarker, Tanner		PHONE NUMBER:	315-771-2777		
JOB TITLE: Distribution Electric Asset Repl		DATE:	SHEET 0 OF 4		
FOREMAN SIG:	EMP ID:	SUPV SIG:			

NEW YORK STATE DEPARTMENT OF ENVIRONMENTAL CONSERVATION
Adirondack Park Agency
RECEIVED
 Date: January 9, 2025

NEW YORK STATE DEPARTMENT OF ENVIRONMENTAL CONSERVATION
Adirondack Park Agency
FINAL
 P2025-0009

GPS: 44.68582, -74.30854
 NEAR 11957 NY-30 MALONE NY
 POLE 312
**TRANSFER OVER PRIMARY
 REPLACE PRIMARY AND SECONDARY GUY WIRES
 TRANSFER 25KVA XMER**

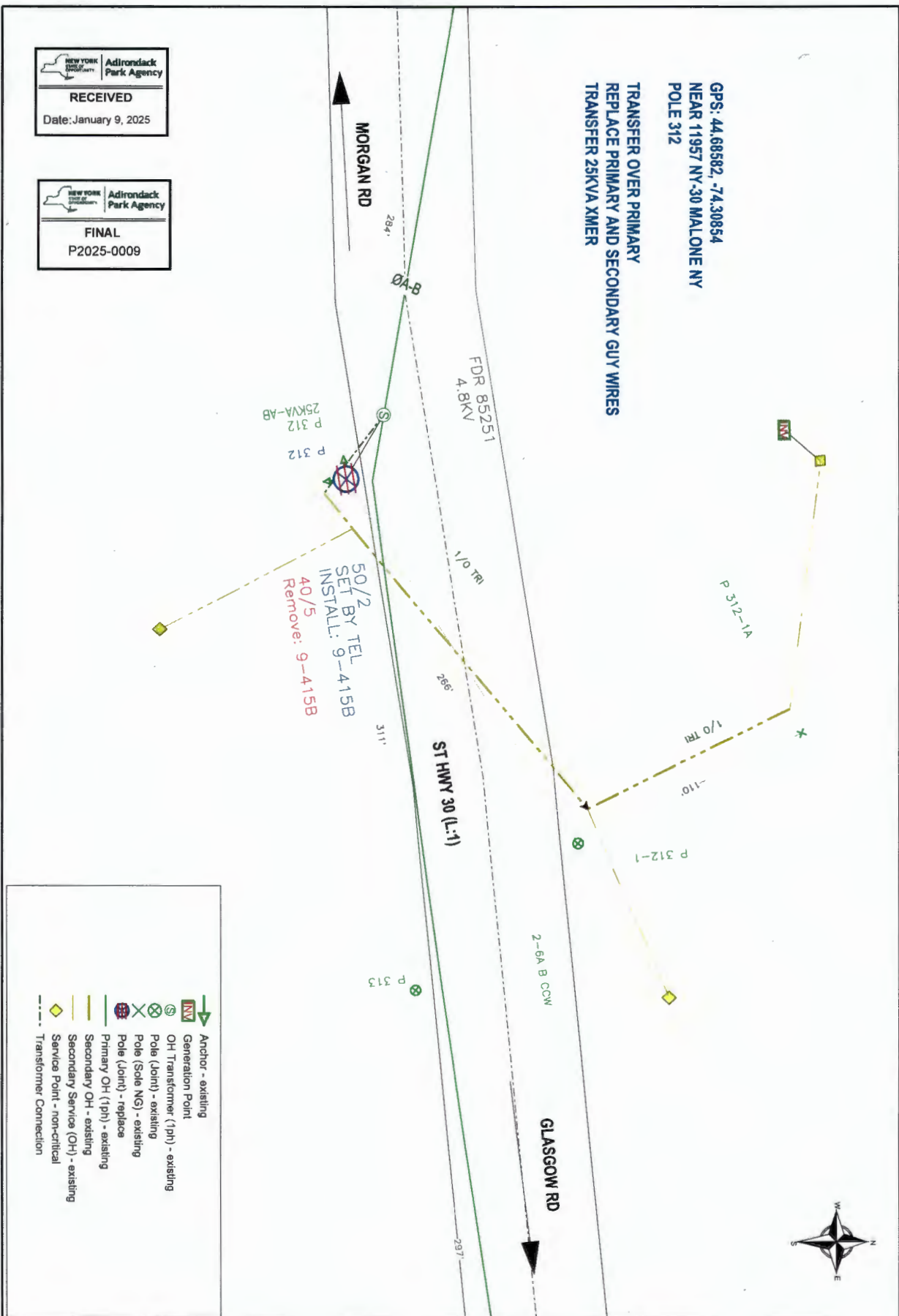

	Anchor - existing
	Generation Point
	OH Transformer (1ph) - existing
	Pole (Joint) - existing
	Pole (Sole NG) - existing
	Pole (Joint) - replace
	Primary OH (1ph) - existing
	Secondary OH - existing
	Secondary Service (OH) - existing
	Service Point - non-critical
	Transformer Connection

NATIONAL GRID USA

27-24-30946933

WORK REQUEST: 27-24-30946933	DESCRIPTION:
STORMS ORDER: 30946933 DATE: 04/05/2024	verion is replacing 4 poles on state hwy 30 in duane. need to transfer national grid equipment/lin
DESIGNER: Rosenbarker, Tanner	
JOB TITLE: Distribution Electric Asset Repl	
FOREMAN SIG:	EMP ID:

<input type="checkbox"/> BUILT AS DESIGNED	T.D./T.C. 6333
<input type="checkbox"/> AS BUILT CHANGES	FEEDER NO. 85251
PHONE NUMBER: 315-771-2777	
DATE:	SHEET 1 OF 4
GROUP SIG:	

0 50 100 FT	
<input type="checkbox"/>	MAINLINE MAP/VOLTAGE CONVERSIONS UPDATE REQUIRED





10-273-10-00 25KVA
 Ph AB Mfg _____ mo/yr _____
 Cutout Type: Non-Parceloin
 Cutout Type: Non-Parceloin
 SERIAL # _____
 17-10
 Ph AB Mfg Allis mo/yr 01/61
 SERIAL # _____

GPS: 44.68582, -74.30511
 NEAR 11920 NY-30 MALONE NY
 POLE 315
**TRANSFER OVER PRIMARY
 REPLACE PRIMARY AND SECONDARY GUY WIRES
 REPLACE XFMR WITH 25KVA**







- Anchor - existing
- OH Transformer (1ph) - replace
- Pole (Joint) - existing
- Pole (Sole NG) - existing
- Pole (Joint) - replace
- Primary OH (1ph) - existing
- Secondary OH - existing
- Secondary Service (OH) - existing
- Service Point - non-critical
- Transformer Connection



NATIONAL GRID USA		27-24-30946933		0 50 100 FT	
WORK REQUEST: 27-24-30946933	DESCRIPTION:	<input type="checkbox"/> BUILT AS DESIGNED	T.D./T.C. 6333	<input type="checkbox"/> MAINLINE MAP/VOLTAGE CONVERSIONS UPDATE REQUIRED	
STORMS ORDER: 30946933 DATE: 04/05/2024	version is replacing 4 poles on state hwy 30 in duane. need to transfer national grid equipment/lin	<input type="checkbox"/> AS BUILT CHANGES	FEEDER NO. 85251		
DESIGNER: Rosenbarker, Tanner		PHONE NUMBER:	315-771-2777		
JOB TITLE: Distribution Electric Asset Repl		DATE:	SHEET 2 OF 4		
FOREMAN SIG:	EMP ID:	SUPV SIG:			

NEW YORK STATE
Adirondack
Park Agency
RECEIVED
Date: January 9, 2025

NEW YORK STATE
Adirondack
Park Agency
FINAL
P2025-0009

-  Anchor - existing
-  OH Transformer (1ph) - existing
-  Pole (Sole NG) - existing
-  Pole (Joint) - replace
-  Primary OH (1ph) - existing
-  Secondary Service (OH) - existing
-  Service Point - non-critical

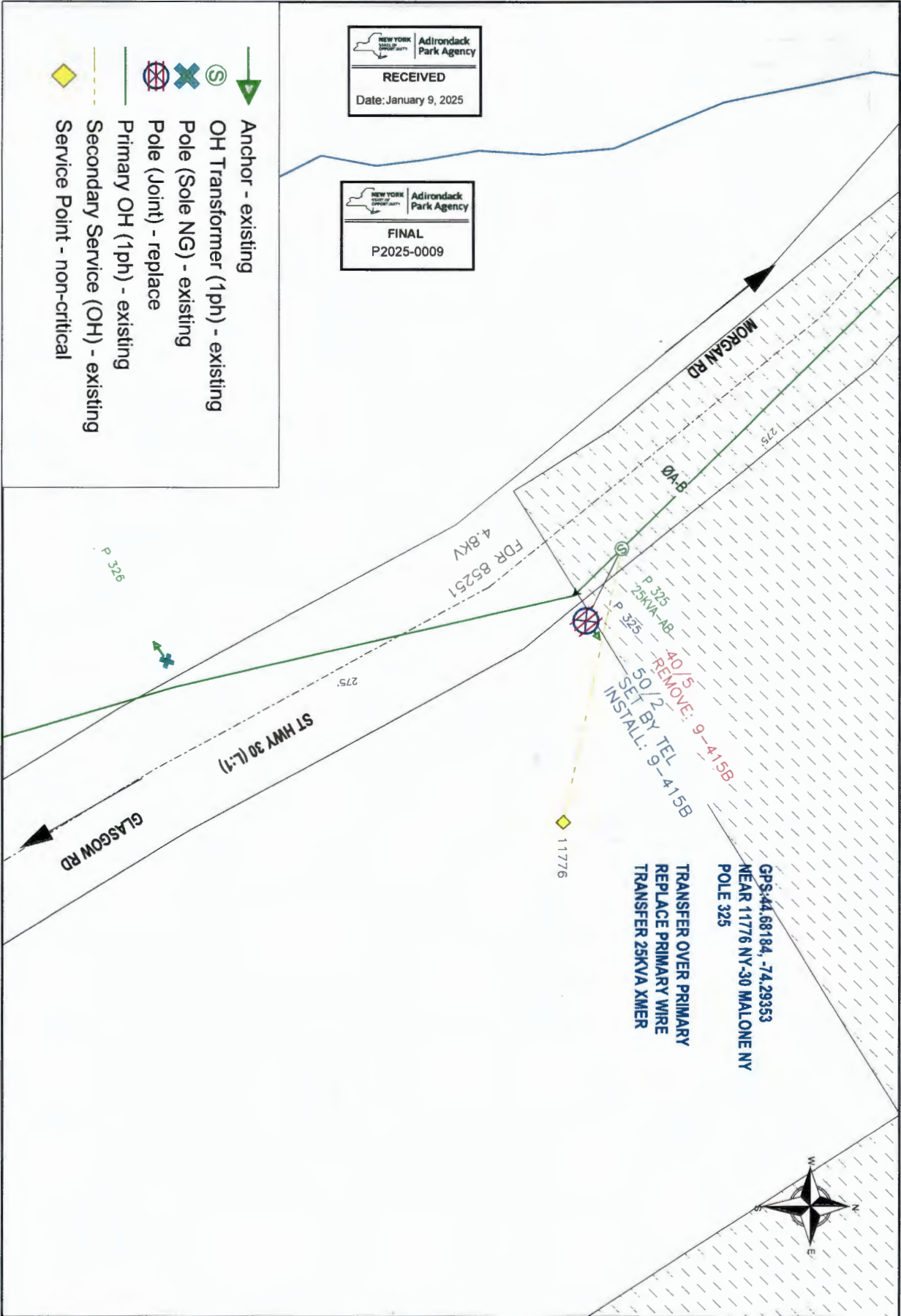

TRANSFER OVER PRIMARY
REPLACE PRIMARY WIRE
TRANSFER 25KVA XMER
POLE 325
GPS: 44.68184, -74.29353
NEAR 11776 NY-30 MALONE NY

REMOVE: 9-415B
SET BY TEL: 9-415B
INSTALL: 9-415B



NATIONAL GRID USA		27-24-30946933	
WORK REQUEST: 27-24-30946933	DESCRIPTION:	<input type="checkbox"/> BUILT AS DESIGNED	T.D/T.C. 6333
STORMS ORDER: 30946933	DATE: 04/06/2024	<input type="checkbox"/> AS BUILT CHANGES	FEEDER NO. 85251
DESIGNER: Rosenbarker, Tanner	verizon is replacing 4 poles on state hwy 30 in duane. need to transfer national grid equipment/lin	PHONE NUMBER: 315-771-2777	DATE: SHEET 3 OF 4
JOB TITLE: Distribution Electric Asset Repl	EMP ID:	DATE:	SUPV SIG:
FOREMAN SIG:			

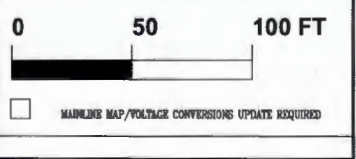

NEW YORK STATE
 RECEIVED
 Adirondack Park Agency
 Date: January 9, 2025

NEW YORK STATE
 Adirondack Park Agency
 FINAL
 P2025-0009

GPS: 44.67891, -74.2916
 NEAR 11743 NY-30 MALONE NY
 POLE 329
 TRANSFER OVER PRIMARY
 REPLACE PRIMARY WIRE
 TRANSFER 10 KVA XMIER

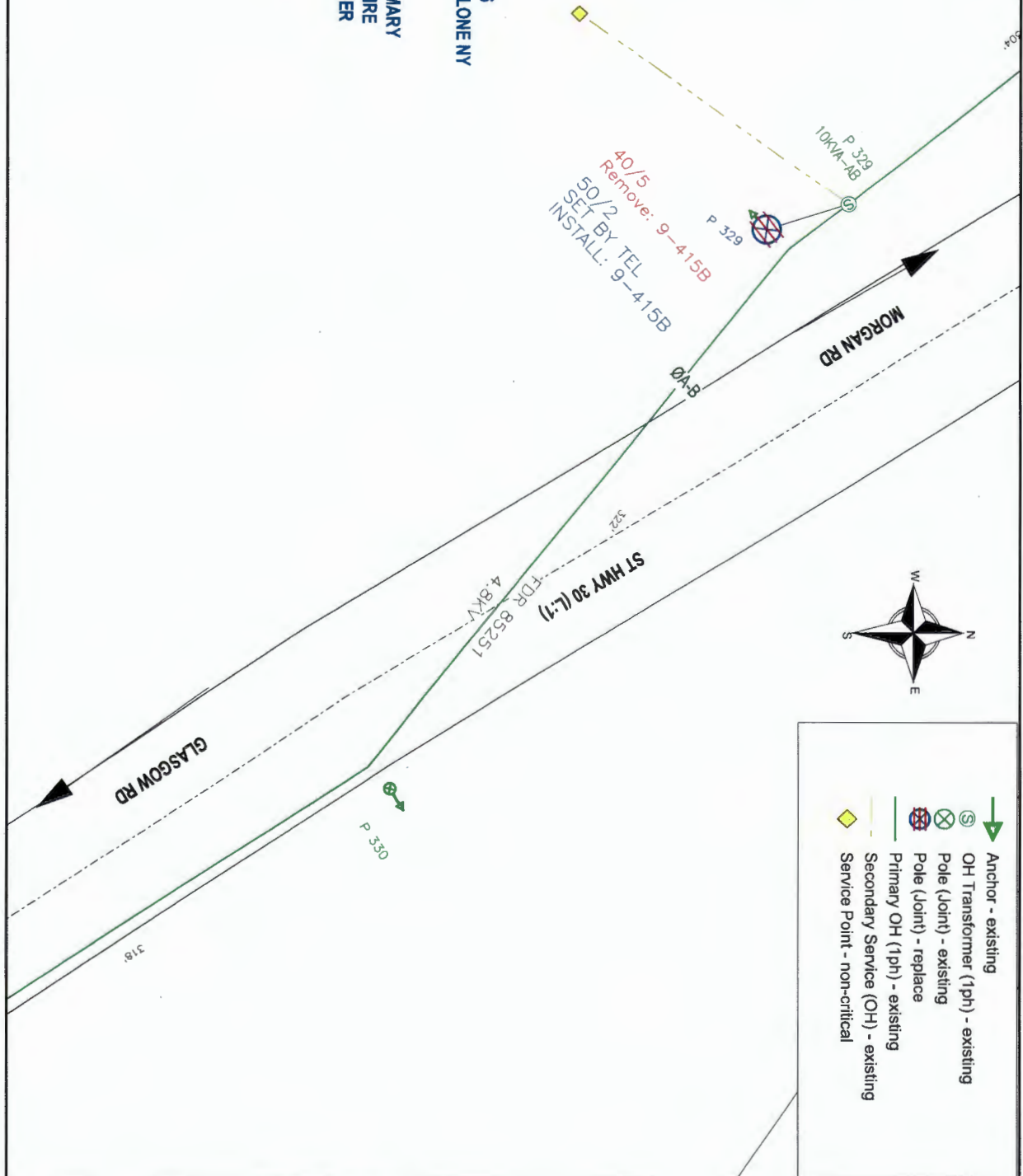

	Anchor - existing
	OH Transformer (1ph) - existing
	Pole (Joint) - existing
	Pole (Joint) - replace
	Primary OH (1ph) - existing
	Secondary Service (OH) - existing
	Service Point - non-critical

NATIONAL GRID USA		27-24-30946933	
WORK REQUEST: 27-24-30946933	DESCRIPTION:	<input type="checkbox"/> BUILT AS DESIGNED	T.D./T.C. 8333
STORMS ORDER: 30946933 DATE: 04/06/2024	version is replacing 4 poles on state hwy 30 in duane. need to transfer national grid equipment/lin	<input type="checkbox"/> AS BUILT CHANGES	FEEDER NO. 85251
DESIGNER: Rosenbarker, Tanner		PHONE NUMBER:	315-771-2777
JOB TITLE: Distribution Electric Asset Repl		DATE:	SHEET 4 OF 4
FOREMAN SIG:	EMP ID:	SUPV SIG:	

0 50 100 FT

MAINLINE MAP/VOLTAGE CONVERSIONS UPDATE REQUIRED

ISSUE	7/24	9-415	CONSTRUCTION STANDARD	OVERHEAD	nationalgrid
	PAGE NUMBER				
1φ (DELTA) AND 3φ DEADEND CROSSARM POLE TOP - 0-15 KV 46° - 60° ANGLES / BACK-TO-BACK DEADENDS (TANGENT)					

1. This clearance can be reduced to a minimum of 56" if needed and if NESG midspan clearances are maintained (see Section 7.11 for required midspan clearances).
2. For single phase delta circuit construction, omit the center phase.

NOTES

SEE 9-200 FOR ADDITIONAL INFORMATION ON MAXIMUM SPANS

SPANS WITH 1/0 TRIPLEX SEC					
SEC BRKT	POLE SIZE	1/0 AAC	336.4 AAC	477 AAC	81.5
ATTACHMENT					81.5
SPANS WITH 1/0 AAC NEUTRAL					
SEC BRKT	POLE SIZE	1/0 AAC	336.4 AAC	477 AAC	81.5
ATTACHMENT					81.5

THIS TABLE BASED ON EQUAL OWNERSHIP PERCENTAGE

107	45 JT-111"	--	--	225
106	45 JT-111"	--	240	--
86	45 JT-111"	300	--	--
81.5	45 JT-111"	255	185	175

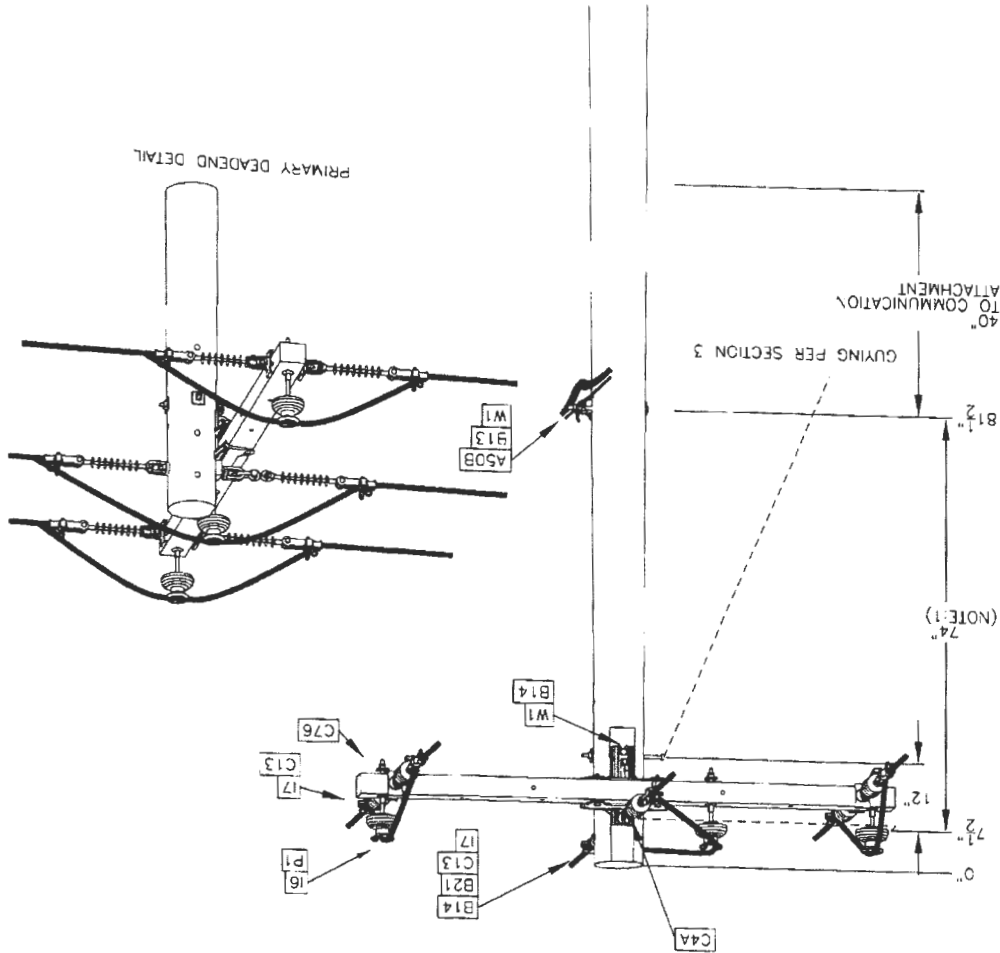

Supersedes 7/20 Issue - Updated Drawing.

FINAL
P2025-009

NEW YORK STATE OF OPPORTUNITY
Adironack Park Agency

RECEIVED
Date: January 9, 2025

NEW YORK STATE OF OPPORTUNITY
Adironack Park Agency

MU = @9-415A	0-15KV 3φ - Bare	MU = @9-415ACL	0-15KV 3φ - Covered
MU = @9-415B	0-15KV 1φ - Bare	MU = @9-415BCL	0-15KV 1φ - Covered