

THIS IS A TWO-SIDED DOCUMENT



**Adirondack
Park Agency**

PO Box 99 · 1133 NYS Route 86
Ray Brook, NY 12977
Tel: (518) 891-4050
www.apa.ny.gov

**APA General
Permit/Order
2019G-1**

Permit #: 2025-0042

**Certification for the Replacement
of Certain Utility Poles**

This certification under General Permit 2019G-1 is granted to National Grid, authorizing the replacement of utility poles as described herein in the Town of Ticonderoga, Essex County.

All terms and conditions of this certification shall apply to the applicant and any individual, contractor, municipality, or other entity undertaking the authorized work on the project site.

This certification does not grant any right to trespass upon the lands or interfere with the riparian rights of others, nor does it authorize the impairment of any easement, right, title, or interest in real or personal property.

Nothing contained in this certification shall be construed to satisfy any legal obligations of the applicant to comply with all applicable laws and regulations or to obtain any governmental approval or permit from any entity other than the Agency, whether federal, state, regional, or local.

PROJECT DESCRIPTION AS PROPOSED

The project as conditionally approved herein involves replacement of eight existing utility poles ranging in height from 34 to 38.5 feet above grade with eight new utility poles ranging in height from 43 to 47.5 feet above grade.

The project is shown on a set of four plan sheets titled "National Grid USA 41-24-30992625 1-10," prepared by National Grid, and dated January 16, 2025 (Site Plan).

A reduced-scale copy of the Site Plan for the project is attached to this certificate for easy reference. The original, full-scale maps and plans described in this paragraph are the official plans for the project, with copies available upon request from Adirondack Park Agency headquarters in Ray Brook, New York.

CONDITIONS

1. The height and location of the replacement utility poles and any associated vegetative cutting and maintenance shall comply with all applicable utility laws, regulations, safety requirements, and company specifications.
2. For projects involving wetlands:
 - a. Whenever practicable, access through wetlands shall occur on frozen ground and with the use of wide-tracked vehicles.

- b. All activities shall occur in compliance with the "Best Management Practice for Preventing the Transportation of Invasive Plant Species," published by Environmental Energy Alliance of New York, 4/26/2012.
 - c. No temporary access structure, including bog mats and work pads, shall be located within a wetland for more than 30 days.
 - d. Existing poles to be replaced shall be removed completely from the wetland, including the portion of the pole that was below grade.
 - e. If any hole left after removal of a pole or created for a replacement pole is to be backfilled with gravel or other ballast, the top six inches shall be covered with organic soil and the final elevation shall be the same as the surrounding wetland surface.
 - f. The total area of wetland disturbance shall be limited to that necessary for replacement of the utility poles.
3. When brought from off-site, all vehicles, construction equipment, and hand excavation tools to be used on the project site shall be clean and free of soil, mud, or other similar material. If washed on the project site, equipment shall be washed in one location to prevent the distribution of propagules among different wash sites. All vehicles, construction equipment, and hand excavation tools used in areas that may contain existing invasive species shall be thoroughly cleaned prior to moving to other areas.
 4. The Agency may conduct on-site investigations, examinations, and evaluations as it deems necessary to ensure compliance with the terms and conditions of this certification.

CERTIFICATION issued this 18th day
of March, 2025.

ADIRONDACK PARK AGENCY

BY: Ariel Lynch
Ariel Lynch
Environmental Program Specialist 3 (EPS3)

STATE OF NEW YORK
COUNTY OF ESSEX

On the 18th day of March in the year 2025, before me, the undersigned, a Notary Public in and for said State, personally appeared Ariel Lynch, personally known to me or proved to me on the basis of satisfactory evidence to be the individual whose name is subscribed to the within instrument and acknowledged to me that they executed the same in their capacity, and that by their signature on the instrument, the individual, or the person upon behalf of which the individual acted, executed the instrument.

Stephanie L. Petith
Notary Public, State of New York
Reg No 01PE6279890
Qualified in Franklin County
Commission Expires April 15, 2025

Stephanie L. Petith
Notary Public

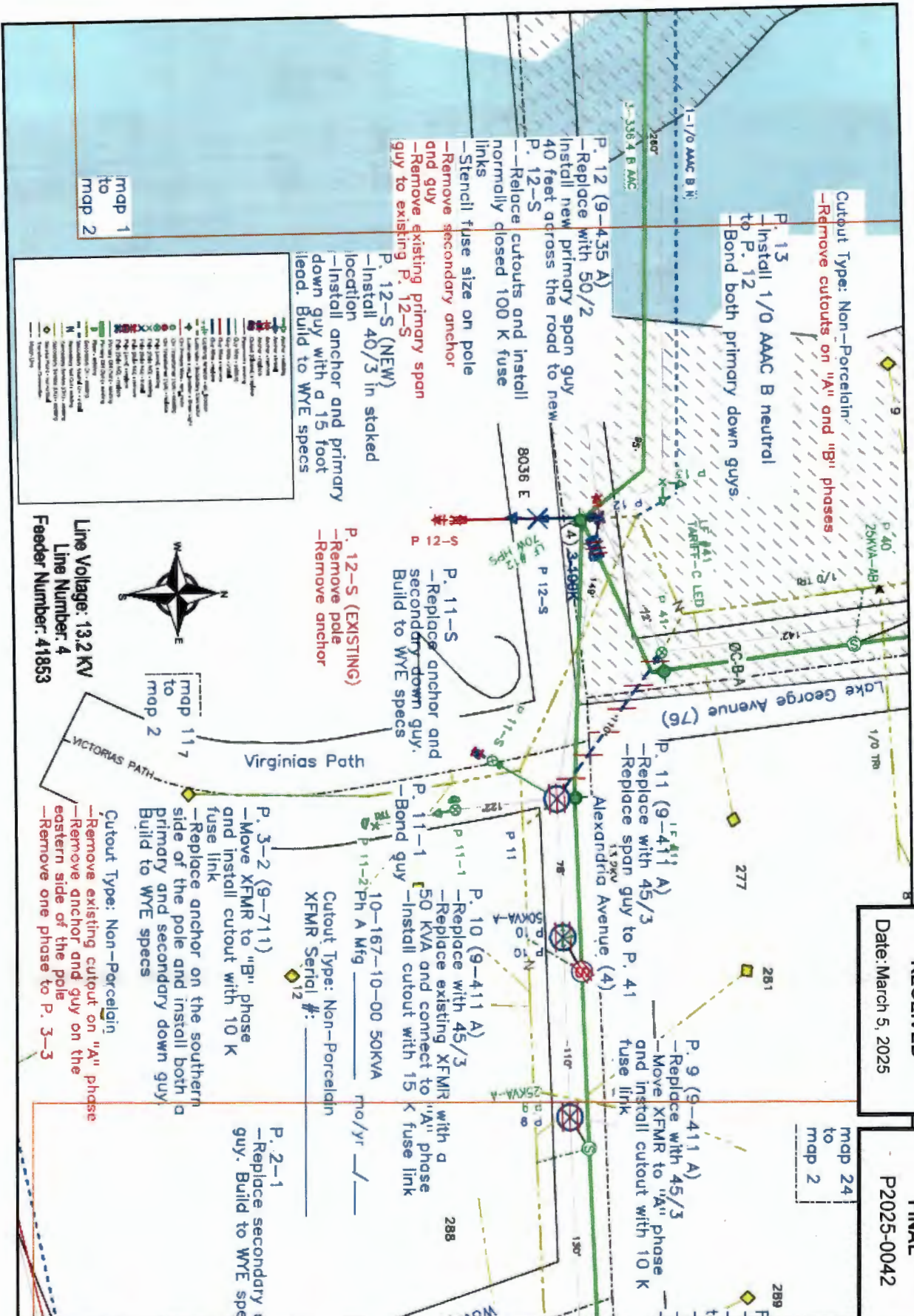

Output Type: Non- porcelain
 - Remove cutouts on "A" and "B" phases

P. 13
 - Install 1/0 AAC B neutral
 - Bond both primary down guys.

P. 12 (9-435 A)
 - Replace with 50/2
 - Install new primary span guy
 - 40 feet address the road to new normally closed 100 K fuse

P. 12-S
 - Remove secondary anchor
 - Remove existing primary span guy to existing P. 12-S

P. 12-S (NEW)
 - Install 40/3 in staked location
 - Install anchor and primary down guy with a 15 foot lead. Build to WYE specs

P. 11-S
 - Replace anchor and secondary down guy.
 - Build to WYE specs

P. 11 (9-411 A)
 - Replace span guy to P. 41

P. 11-1
 - Bond guy

P. 10 (9-411 A)
 - Replace with 45/3
 - Replace existing XFMR with a 50 KVA and connect to P. 11-1
 - Install cutout with 15 K fuse link

P. 10-167-10-00 50KVA
 - 10-167-10-00 50KVA

P. 9 (9-411 A)
 - Replace with 45/3
 - Move XFMR to "A" phase and install cutout with 10 K fuse link

P. 3-2 (9-711)
 - Move XFMR to "B" phase and install cutout with 10 K fuse link
 - Replace anchor on the southern side of the pole and install both a primary and secondary down guy
 - Build to WYE specs

P. 3-3
 - Remove one phase to P. 3-3

P. 2-1
 - Replace secondary guy. Build to WYE specs

Cutout Type: Non- porcelain
 - Remove existing cutout on "A" phase
 - Remove anchor and guy on the eastern side of the pole
 - Remove one phase to P. 3-3

Cutout Type: Non- porcelain
 XFMR Serial #: 12

map 24 to map 2

map 117 to map 2

map 1 to map 2

Line Voltage: 13.2 KV
 Line Number: 4
 Feeder Number: 41853

RECEIVED
 Adirondack Park Agency
 Date: March 5, 2025

FINAL
 Adirondack Park Agency
 P2025-0042

NATIONAL GRID USA
 41-24-30992625 1-10

WORK REQUEST: 41-24-30992625
 ORDER NUMBER: 30992625 DATE: 01/10/2025
 DESIGNER: Callahan, Thomas
 JOB TITLE: Hedge 63 - Alexandria Ave Corridor
 FOREMAN: JCS

DESCRIPTION:
 Please refer to the BALLET for engineering review once design is complete.
 Date of this sheet: 1/10/25

DESIGN AS SHOWN T.O./T.D. 41
 AS BUILT CHANGES
 PERIOD STARTING: 01-10-2025
 DATE: 01-10-2025
 DRAWN BY: JCS

0 50 100 FT
 SCALE BAR

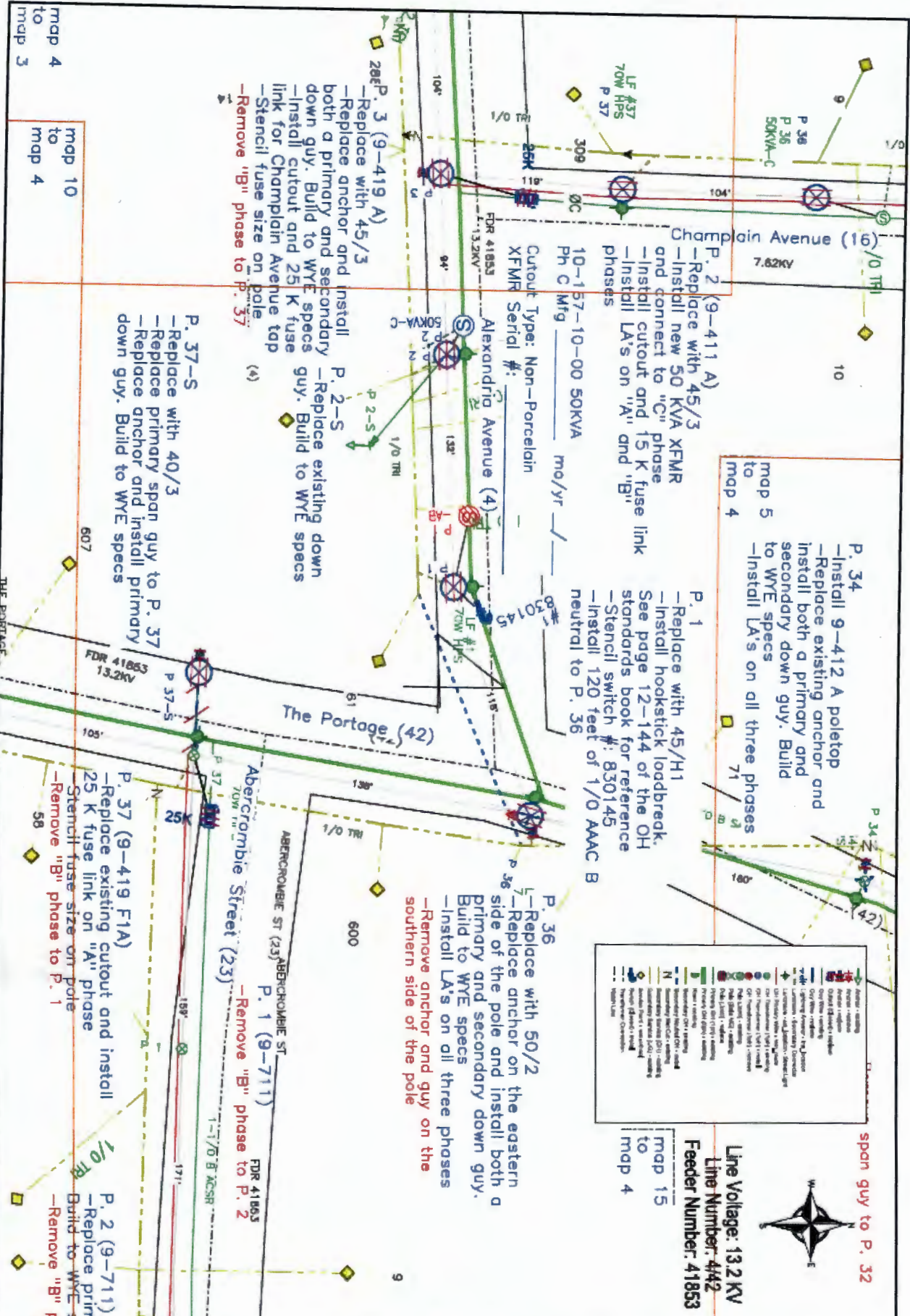

NATIONAL GRID USA 41-24-30992625 1-10		0 50 100 FT MAXIMIZE XHP/POLICE CONFORMANCE RIGHTS RESERVED	
WORK NUMBER: 41-24-30992625 PROJECT NUMBER: 00000000 DESIGNED: Callahan, Thomas AEC TITLE: Regis 60 - Alexandria Area Center PREPARED BY:	DATE: 01/16/2005 Please assign 887 to HALLEY for engineering review once design is complete. Date of this sheet:	V.07/2.41 FIELD NO. 41863 518-802-0490 SHEET 4 OF 80	10/2/04 FIELD NO. 41863 518-802-0490 SHEET 4 OF 80

map 4 to map 3
map 10 to map 4
map 5 to map 4
map 15 to map 4

map 10
to
map 4

Legend

- Current location - no jacket
- Line Voltage: 4.8 KV
- Line Number: 42
- Feeder Number: 41853

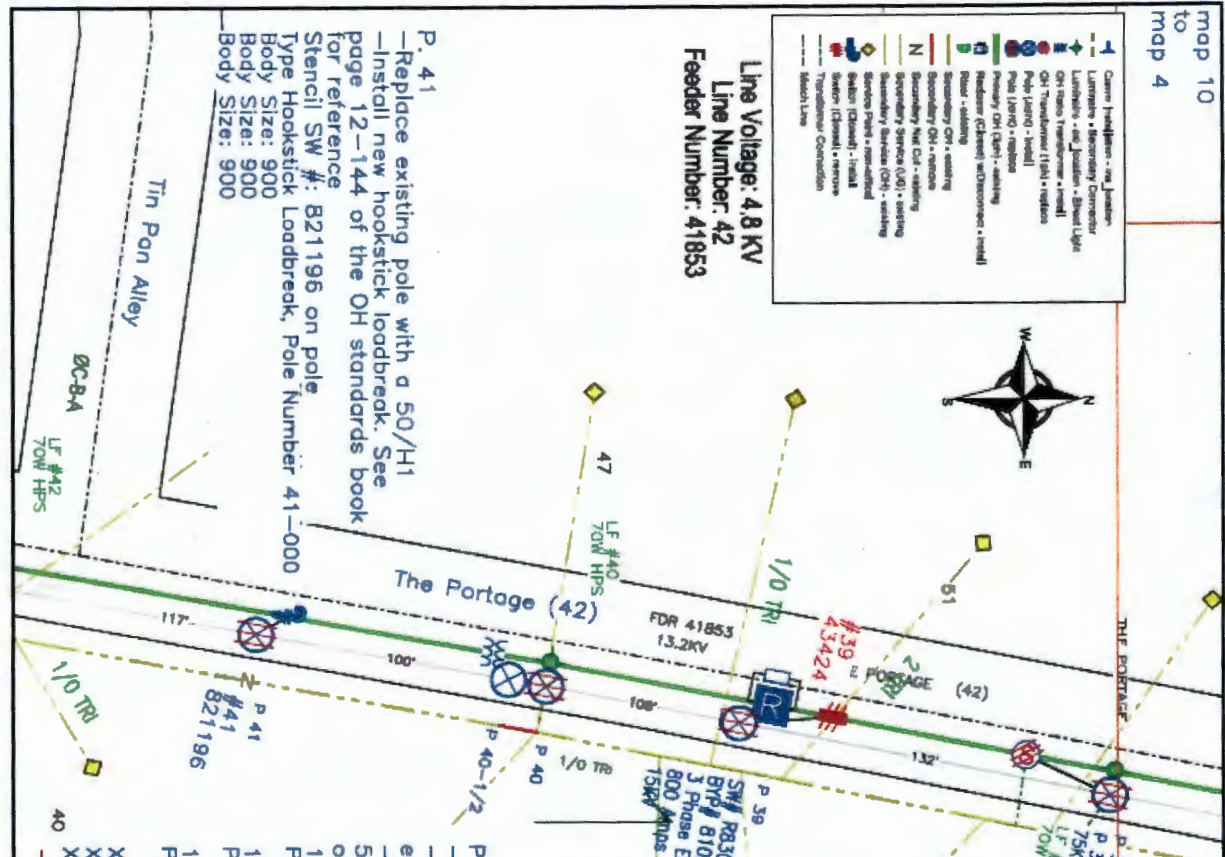

P. 38 (9-411 A)
 -Replace with 45/3
 -Replace existing XFMR with a 75 KVA and connect to "C" phase
 -Install cutout with 25 K fuse link
 10-167-10-00 75KVA Ph C Mfg _____ mo/yr ____
 Cutout Type: Non- porcelain
 XFMR Serial #: _____

P. 39
 -Replace with 50/H1
 -Install the recloser being relocated from P. 16 on Alexandria Avenue
 -Install radio package for recloser
 -Stencil recloser #: R830208
 -Stencil bypass #: 810344
 -Mount controls at 5 feet and install TG2 YA ground grid
 Model: Orbit MCR-4G
 Serial Number: _____
 Mfg Name: MDS
 Mfg. Date: _____

P. 40 and P. 40 1/2
 -Remove existing switches

P. 40
 -Replace existing P. 92 with a 55/2
 -Install new 55/2 16 feet south of existing P. 40 and stencil as P. 40 1/2
 -Install platform mount for new bank of 500 KVA ratios. Refer to page 14-377 of the OH standards book
 10-119-44-00 500KVA Ph A Mfg _____ mo/yr ____
 10-119-44-00 500KVA Ph B Mfg _____ mo/yr ____
 10-119-44-00 500KVA Ph C Mfg _____ mo/yr ____

P. 41
 -Replace existing pole with a 50/H1
 -Install new hookstick loadbreak. See page 12-144 of the OH standards book for reference
 Stencil SW #: B21196 on pole
 Type Hookstick Loadbreak, Pole Number 41-000
 Body Size: 900
 Body Size: 900
 Body Size: 900

Remove "B" phase to P. 1

Remove "B" phase to P. 3

map 23
to
map 10

NATIONAL GRID USA 41-24-30992625 1-10		0 50 100 FT	
WORK NUMBER: 41-24-30992625 DRAWING NUMBER: 00000000 DATE: 01/16/2008 DESIGNER: Callahan, Thomas JOB TITLE: Regio 83 - Alexandria Ave Corridor FOREMAN NO:	Description: Please refer to GALLERY for engineering review once design is complete. Date of Rev: 02/16/08	<input type="checkbox"/> ONLY AS DESCRIBED T.O./Y.D. 41 <input type="checkbox"/> AS SHOWN OTHERWISE PERMITS NO. 41853 PERMITS NUMBER: 616-208-0400 DATE: PERMITS 10 OF 20 DRAWING NO.	<input type="checkbox"/>

